

P143 Standard Parts

Item	Description		Part Number
1	Bonnet Cap	With gasket for Standard, acetal	610-065-000/ 662-230-000
2	Adjustment Screw, Acetal		648-528-000
3	Vent	Subassembly	822-036-000
4	Vent	Collar (2 required)	612-008-000
5	Diaphragms		
	Standard Diaphragm, plate & washer nitrile		804-265-001
6	Standard Bodies	3/4" x 3/4" Port Iron	664-357-000
		3/4" x 1" Port Iron	664-357-002
		1" x 1" Port Iron	664-357-001
		1" x 1-1/4" Port Iron	664-357-003
7	Standard Orifice - Aluminum	1/8"	688-053-000
		3/16"	688-053-001
		1/4"	688-053-002
		5/16"	688-053-003
		3/8"	688-053-004
		1/2"	688-053-005
	5/8"	688-053-006	
8	Main Seat, nitrile		650-168-000
9	Square Ring		662-226-000
10	Housing Nut & Retaining Ring,		803-073-000
11	Build Screws, plated steel (8 required)		648-529-000

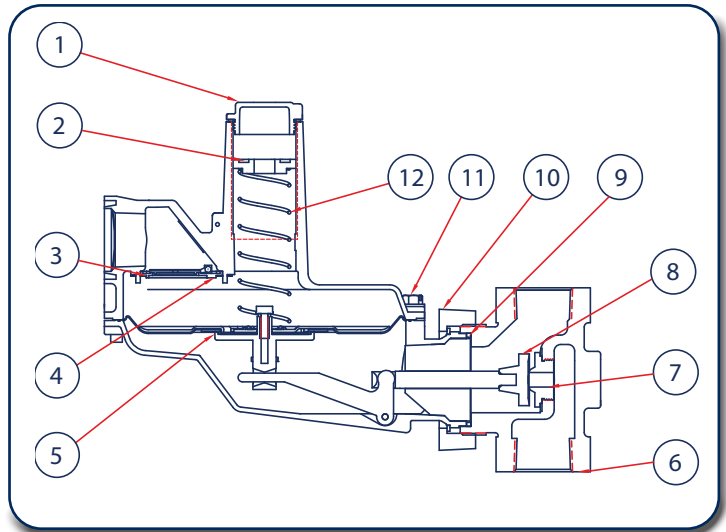

P143 Standard Model Flow Capacities

Capacity* in SCFH Natural Gas
(0.6 specific gravity – 14.65 PSIG – 65°F)

Body Size 3/4" x 3/4"							
Inlet	Orifice						
PSIG	1/8"	3/16"	1/4"	5/16"	3/8"	1/2"	5/8"
1/2	-	-	-	-	340	450	510
1	-	-	-	480	500	510	530
2	-	-	530	560	570	580	600
3	-	420	600	560	630	650	670
5	250	560	700	720	730	770	790
7.5	310	700	840	860	880	900	900
10	370	830	950	970	1000	1020	1020
20	530	1200	1220	1240	1250	1270	-
40	860	1570	1330	1340	1450	-	-
60	1200	1660	1520	-	-	-	-
80	1500	1710	-	-	-	-	-
125	1800	1900	-	-	-	-	-

Body Size 3/4" x 1" • 1" X 1"							
Inlet	Orifice						
PSIG	1/8"	3/16"	1/4"	5/16"	3/8"	1/2"	5/8"
1/2	-	-	-	-	350	460	520
1	-	-	-	480	550	600	650
2	-	-	530	700	840	880	780
3	-	420	650	870	1000	920	810
5	250	580	890	1120	1160	950	970
7.5	310	700	1140	1340	1270	1140	1060
10	370	840	1360	1500	1330	1200	1180
20	530	1230	2000	1600	1480	1400	-
40	860	1700	2000	1640	1900	-	-
60	1200	1900	2000	-	-	-	-
80	1540	2000	-	-	-	-	-
125	2100	2100	-	-	-	-	-

Body Size 1" X 1-1/4" • 1-1/4" X 1-1/4"							
Inlet	Orifice						
PSIG	1/8"	3/16"	1/4"	5/16"	3/8"	1/2"	5/8"
1/2	-	-	-	-	350	460	520
1	-	-	-	480	550	680	760
2	-	-	530	700	840	1020	1030
3	-	420	650	870	1030	1200	1050
5	250	580	890	1180	1350	1490	1060
7.5	310	700	1140	1500	1610	1580	1060
10	370	840	1360	1700	1710	1800	1180
20	630	1230	1600	1800	1900	1900	-
40	860	1800	2200	1900	2000	-	-
60	1200	2100	2400	-	-	-	-
80	1550	2200	-	-	-	-	-
125	2250	2400	-	-	-	-	-

*Consult manufacturer for test conditions

P143 Standard Dimensions

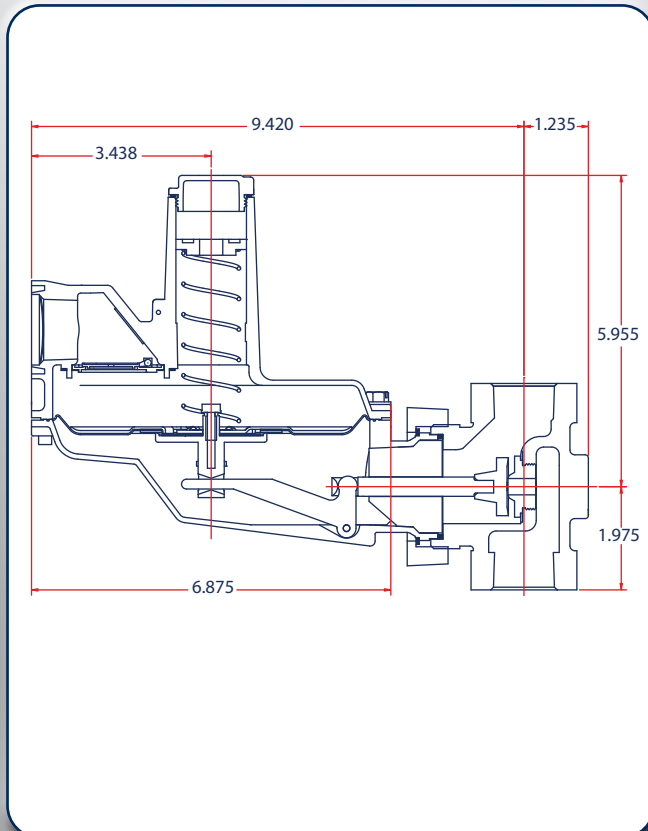

P143 Low Pressure Cut Off Parts

Item	Description	Part Number	
1	Bonnet Cap With gasket for LPCO, Aluminum	610-062-000/ 662-230-000	
2	Adjustment Screw, Acetal	648-528-000	
3	Vent	Collar (2 required)	612-008-000
4		Subassembly	822-036-000
5	Diaphragms		
	LPCO Diaphragm, plate & washer, nitrile	804-265-000	
6	LPCO Bodies	3/4" x 3/4" Port Iron	664-351-000
		3/4" x 1" Port Iron	664-351-002
		1" x 1" Port Iron	664-351-001
		1" x 1-1/4" Port Iron	664-351-003
		1-1/4" x 1-1/4" Port Iron	664-351-004
7	LPCO Bottom Plug Assembly	819-008-000	
8	LPCO Cutoff Seat Assembly	810-043-000	
9	LPCO Orifice - Aluminum	1/4" - Double Sided	688-052-000
		5/16" - Double Sided	688-052-001
		3/8" - Double Sided	688-052-002
		7/16" - Double Sided	688-052-003
10	Main Seat, nitrile	650-168-000	
11	Square Ring	662-226-000	
12	Housing Nut & Retaining Ring	803-073-000	
13	Build Screws, plated steel (8 required)	648-529-000	

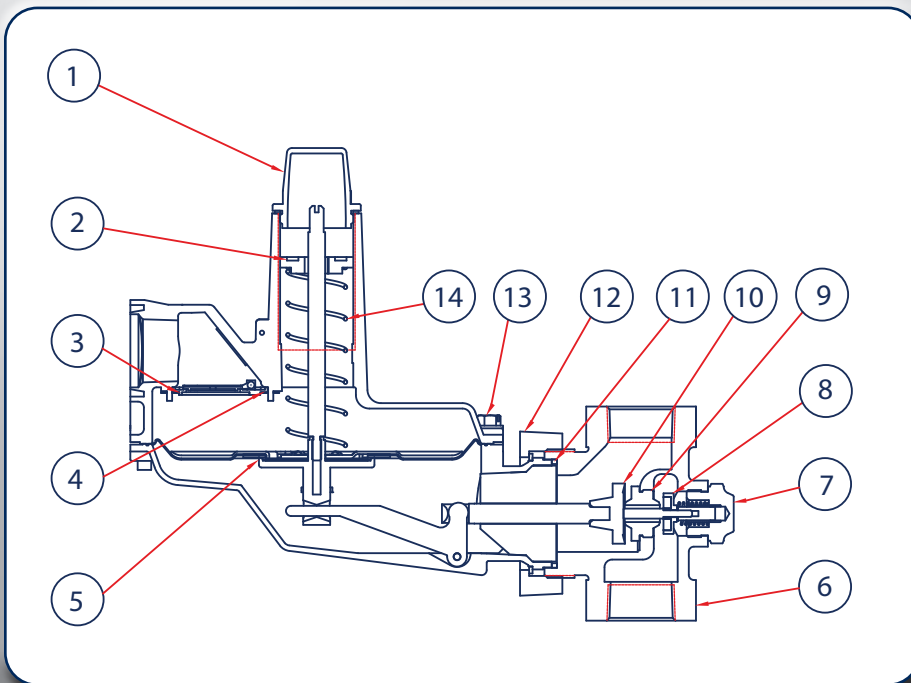

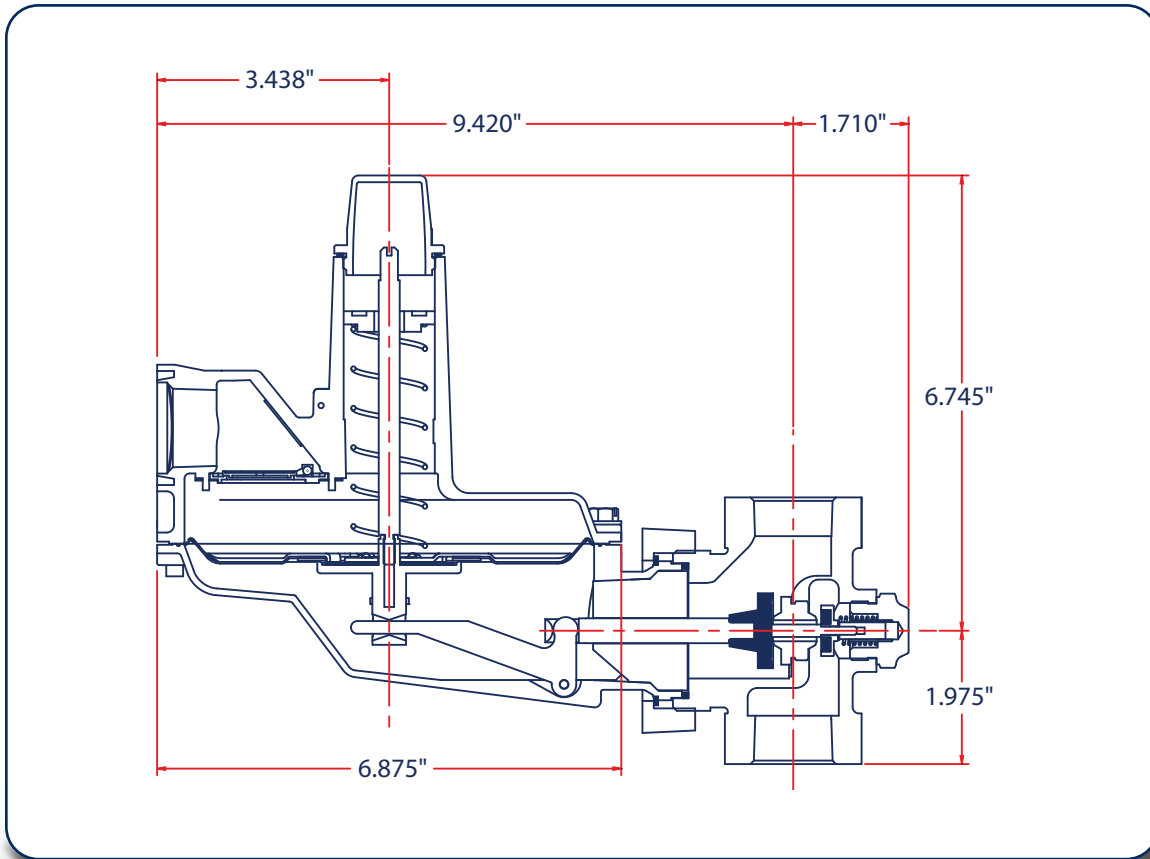

P143 LPCO Flow Capacities

Capacity* in SCFH Natural Gas
(0.6 specific gravity – 14.65 PSIG –65°F)

Pipe Size (inches)	Inlet Pressure (PSIG)		Outlet Pressure Red Spring 4 – 7-1/2" WC Blue Spring 6-1/2" – 9-1/2" WC				Outlet Pressure Green Spring 7-1/2 – 15" WC			
			Orifice Size, Inches				Orifice Size, Inches			
			7/16	3/8	5/16	1/4	7/16	3/8	5/16	1/4
3/4" x 3/4"	1/2	.034	240	180	90		140	120	90	
	1	.068	400	300	200	100	250	200	160	90
	2	.137	580	420	300	140	370	320	240	140
	5	.344	800	750	600	230	580	530	460	220
	10	.684	1050	990	740	380	780	720	700	370
	15	1.03	1140	1050	950	46	920	860	800	480
	25	1.72		1100	1100	640		900	1000	660
	40	2.75			1300	870			1300	910
	60	4.14				1160				1160
3/4" x 1" 1" x 1"	1/2	.034	270	210	90		160	120	90	
	1	.068	430	310	210	100	260	230	160	90
	2	.137	650	420	300	140	410	350	270	140
	5	.344	1100	750	610	230	800	730	470	220
	10	.684	1300	1120	760	380	1220	1090	740	370
	15	1.03	1300	1300	960	460	1300	1300	930	480
	25	1.72		1300	1300	640		1300	1160	660
	40	2.75			1300	870			1300	910
	60	4.14				1160				1160
1" x 1-1/4" 1-1/4" x 1-1/4"	1/2	.034	270	210	90		160	120	90	
	1	.068	430	310	210	100	260	230	160	90
	2	.137	650	420	300	140	430	350	270	140
	5	.344	1100	750	510	230	870	730	470	220
	10	.684	1300	1120	760	380	1300	1090	740	370
	15	1.03	1300	1300	960	460	1300	1300	930	480
	25	1.72		1300	1300	640		1300	1160	660
	40	2.75			1300	870			1300	910
	60	4.14				1160				1160

*Consult manufacturer for test conditions

P143 RELIEF CURVES 2 PSIG SET POINT, LEVER DISCONNECT

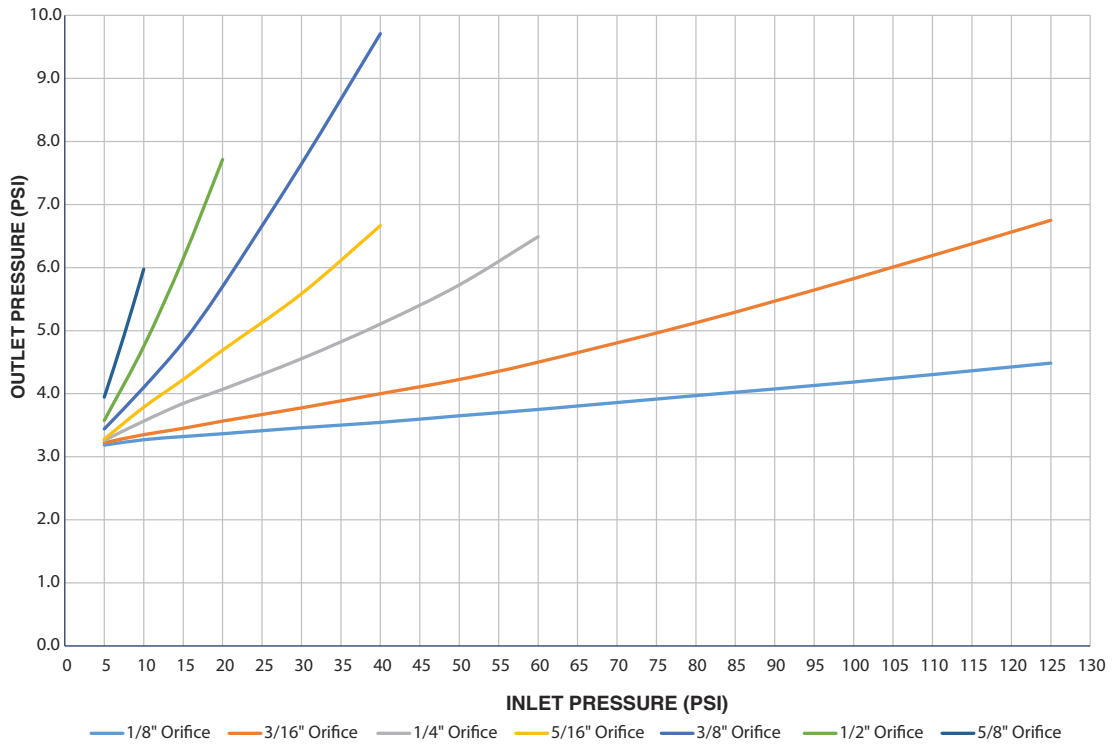

P143 RELIEF CURVES 7" W.C. SET POINT, LEVER DISCONNECT

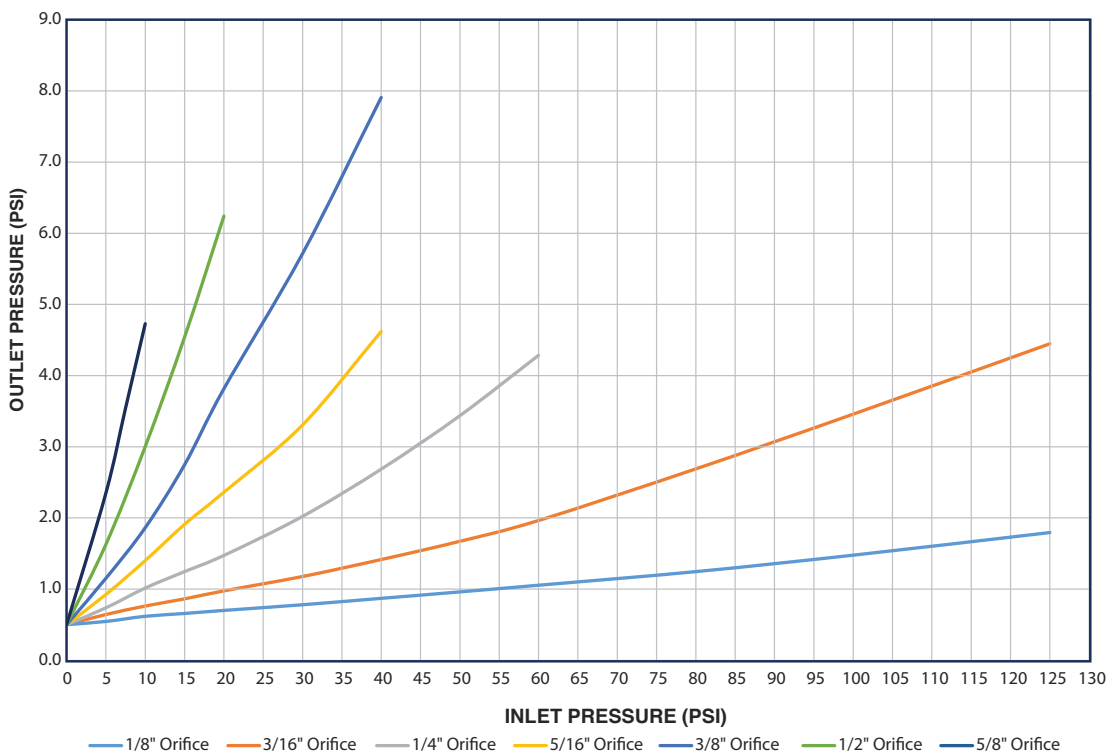

P140 Flow Capacities in SCFH of 0.6 Specific Natural Gas

Outlet Pressure, Spring Part No., Accuracy	NPT 3/4" Outlet Body Size								NPT 1" Outlet Body Size						NPT 1-1/4" Outlet Body Size					
	Inlet		Orifice						Orifice						Orifice					
	PSIG	BAR	1/8"	3/16"	1/4"	5/16"	3/8"	1/2"	1/8"	3/16"	1/4"	5/16"	3/8"	1/2"	1/8"	3/16"	1/4"	5/16"	3/8"	1/2"
7" WC Set Pressure 655-791-001 Brown 1" WC Droop	0.5	0.04	56	72	82	160	200	260	66	92	140	180	215	275	66	92	140	180	305	305
	1	0.07	61	87	180	250	280	365	82	145	210	280	305	410	82	145	310	325	330	450
	3	0.20	102	289	320	450	530	500	172	315	355	510	580	810	172	340	435	520	590	810
	5	0.30	208	375	450	602	715	806	218	405	510	730	830	1110	310	480	510	730	880	1110
	10	0.70	320	590	800	940	1090	1320	345	630	860	1110	1310	1555	350	710	860	1150	1520	1575
	15	1.00	380	750	1000	1320	1425		428	855	1210	1555	1650		525	980	1210	1565	1760	
	20	1.40	500	1046	1320	1510	1510		550	1110	1450	1855	2010		610	1250	1555	2070	2415	
	40	2.80	795	1600	1905				845	1750	2210				940	1755	2505			
	60	4.10	1000	2005	2110				1155	2310	2505				1270	2505	2505			
	100	6.90	1700	2110					1805	2505					1910	2505				
14" WC Set Pressure 655-791-003 Silver 2" WC Droop	2	0.14	75	200	270	390	400	555	70	220	305	435	460	830	140	210	330	395	460	830
	5	0.34	155	360	500	630	660	885	235	395	560	720	750	1230	235	395	560	720	750	1350
	10	0.69	350	550	750	965	1000	1230	375	610	825	1055	1140	1660	375	610	825	1120	1195	1720
	15	1.00	420	720	900	1255	1350		460	810	1080	1350	1475		375	810	1135	1375	1650	
	20	1.40	565	900	1250	1430	1575		610	1020	1330	1640	1810		630	1020	1395	1680	2025	
	30	2.10	745	1240	1550	1755			805	1350	1760	1955			815	1490	2075	2320		
	60	4.10	1230	1955	2210				1310	2255	2505				1330	2750	3420			
	80	5.50	1555	2300					1905	2580					1960	3435				
	100	6.90	1645	2500					2200	2710					1960	4020				
	125	8.60	2000	2700					2200	2905					2260	4320				
1 PSIG Set Pressure 655-791-003 Silver 1% Droop	2	0.14	95	220	270	290	380	410	85	235	305	340	430	460	140	295	330	340	430	520
	5	0.34	200	345	440	590	630	720	235	395	500	660	715	800	280	400	520	665	715	800
	10	0.69	330	525	700	870	1000	1000	370	580	780	1025	1135	1150	370	590	780	1035	1150	1280
	15	1.00	420	735	950	1200	1300		465	770	1055	1280	1420		465	790	1075	1280	1435	
	20	1.40	520	900	1200	1400	1620		580	990	1355	1560	1730		580	1020	1370	1590	1730	
	30	2.10	700	1150	1640	1750			800	1340	1860	2020			800	1365	1890	2040		
	60	4.10	1200	1920	2250				1280	2410	2860				1280	2580	2900			
	80	5.50	1550	2110					1705	2900					1720	3400				
	100	6.90	1660	2150					1905	3155					1935	3420				
	125	8.60	1770	2160					2105	3310					2210	3620				
2 PSIG Set Pressure 655-791-004 Yellow/Black 1% Droop	5	0.34	125	205	260	360	380	300	130	225	290	410	420	485	130	180	250	280	300	395
	10	0.69	210	340	440	690	690	850	235	375	490	735	760	850	260	420	585	755	775	870
	15	1.00	270	450	600	900	900		310	505	655	1010	1010		370	530	67	1060	1120	
	20	1.38	340	550	760	1080	1080		375	610	850	1210	1210		430	625	860	1290	1320	
	30	2.10	450	850	1100	1450			510	905	1240	1620			535	930	1250	1720		
	60	4.10	880	1500	2040				960	1620	2250				960	1660	2300			
	80	5.52	1100	1910					1210	2010					1290	2110				
	100	6.90	1430	1910					1600	2410					1720	2490				
	125	8.60	1760	2115					2110	3320					2150	3420				
5 PSIG Set Pressure 655-791-006 White 1% Droop	10	0.69	125	155	200	275	290	580	120	155	225	245	305	335	180	250	310	375	450	660
	15	1.00	125	155	200	275	290		135	170	230	290	335		160	205	270	310	380	
	20	1.38	140	175	240	275	350		165	200	270	315	390		165	235	330	370	450	
	30	2.10	170	225	290	360			200	270	330	415			225	330	420	435		
	60	4.10	180	350	500				300	400	555				355	455	600			
	80	5.52	300	420					370	490					490	640				
	100	6.90	380	520					430	590					500	700				
	125	8.60	450	620					515	710					650	870				

P140 Relief Curves

1" outlet, 1" vent port, 7" WC regulator set point

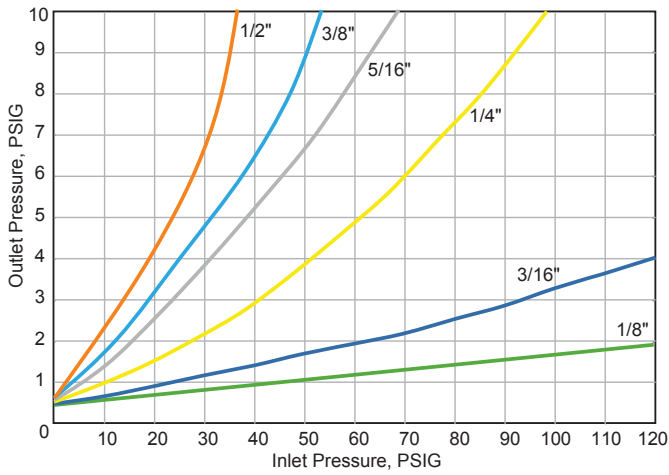

1" outlet, 1" vent port, 14" WC regulator set point

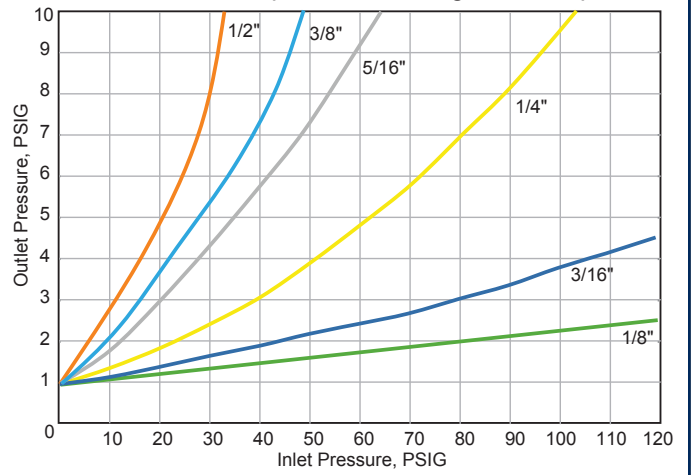

1" outlet, 1" vent port, 1 PSIG regulator set point

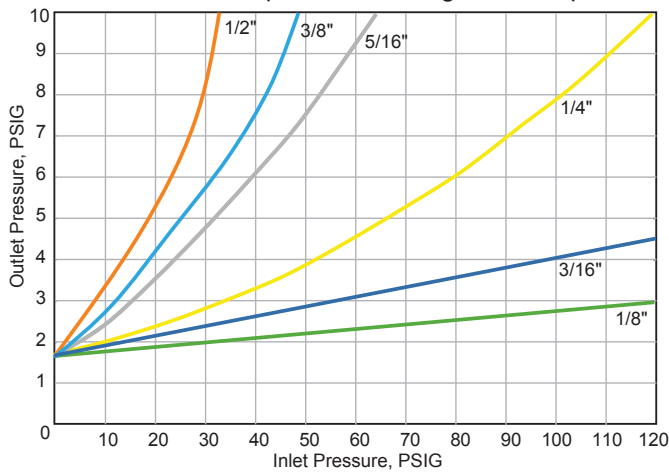

1" outlet, 1" vent port, 2 PSIG regulator set point

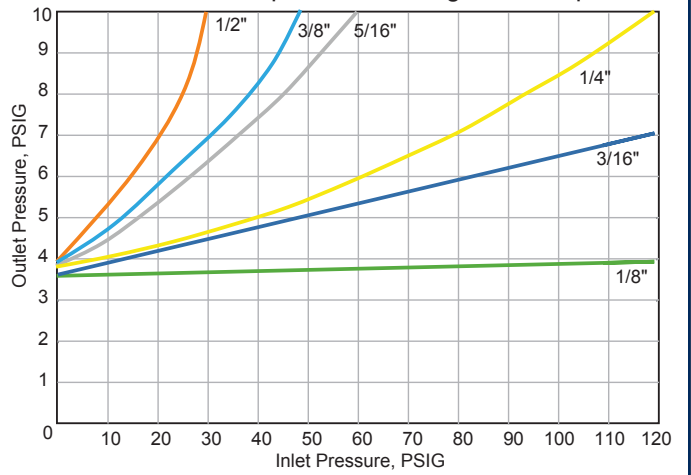

1" outlet, 1" vent port, 5 PSIG regulator set point

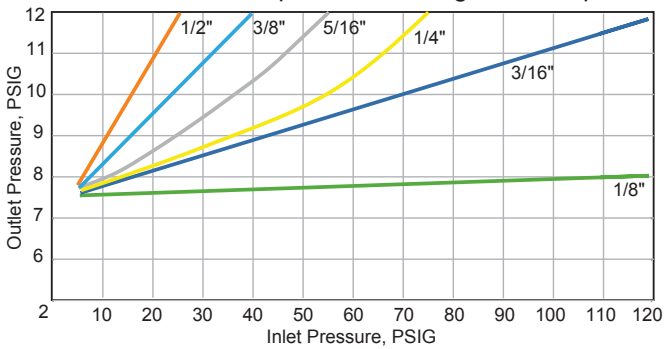

P140 Standard Parts

Item	Description	Qty.	Part Number
1	Bonnet Cap w/ gasket	1	812-035-000
	Red Bonnet Cap w/ gasket	1	812-036-000
	Bonnet (5"-7" up to 1-2 psi)	1	604-291-000
	Bonnet (2-4 psi up to 4-5 psi)		604-292-000
3	Adjustment Screw - 5" to 2 PSIG	1	648-581-000
	Adjustment Screw - 2 to 5 PSIG		648-581-001
3	Range Springs	1	
	5"-7" WC, Green		655-791-000
	6"-8" WC, Brown		655-791-001
	8"-14" WC, Blue		655-791-002
	12"-28" WC, Silver		655-791-003
	1-2 PSIG, Yellow/Black		655-791-004
	2-4 PSIG, Yellow		655-791-005
4-5 PSIG, White	655-791-006		
4	Aluminum Orifices	1	
	Orifice - 1/8"		688-076-000
	Orifice - 3/16"		688-076-001
	Orifice - 1/4"		688-076-002
	Orifice - 5/16"		688-076-003
	Orifice - 3/8"		688-076-004
5	Cast Iron Bodies	1	
	Iron Body - 3/4" NPT straight		664-449-000
	Iron Body - 3/4" NPT angle		664-450-000
	Iron Body - 3/4" x 1" NPT straight		664-451-000
	Iron Body - 3/4" x 1" NPT angle		664-452-000
	Iron Body - 1" NPT straight		664-453-000
	Iron Body - 1" NPT angle		664-454-000
	Iron Body - 1 1/4" NPT straight		664-455-000
	Iron Body - 1 1/4" NPT angle		664-456-000
6	Relief Springs	1	
	5" above set, Orange		655-792-000
	6" above set, Red		655-792-001
	7" above set, Purple		655-792-002
6	9" above set, Black	1	655-792-003
7	Seat assembly - Nitrile	1	650-204-000
8	Steel Build Bolt (Not Shown)	4	648-587-000
9	Steel Body Bolt (Not Shown)	2	648-587-001
10	Body Gasket	1	624-112-000
11	Non-relieving Diaphragm Assembly		804-296-000
	Relieving Diaphragm Assembly - 5"	1	804-297-000
	Relieving Diaphragm Assembly - 6"	1	804-297-001
	Relieving Diaphragm Assembly - 7"	1	804-297-002
	Relieving Diaphragm Assembly - 9"	1	804-297-003

P140 Dimensions

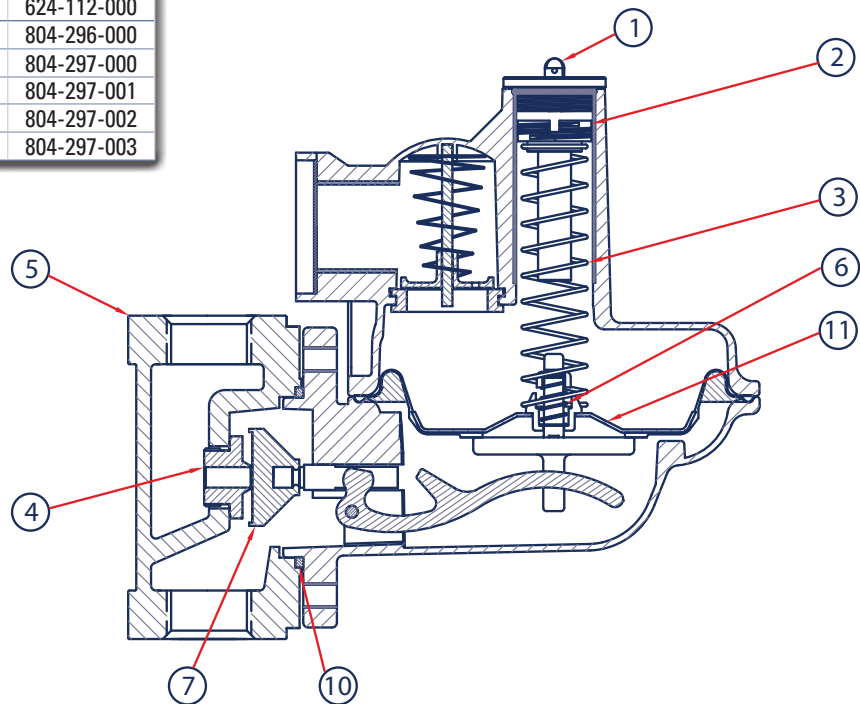
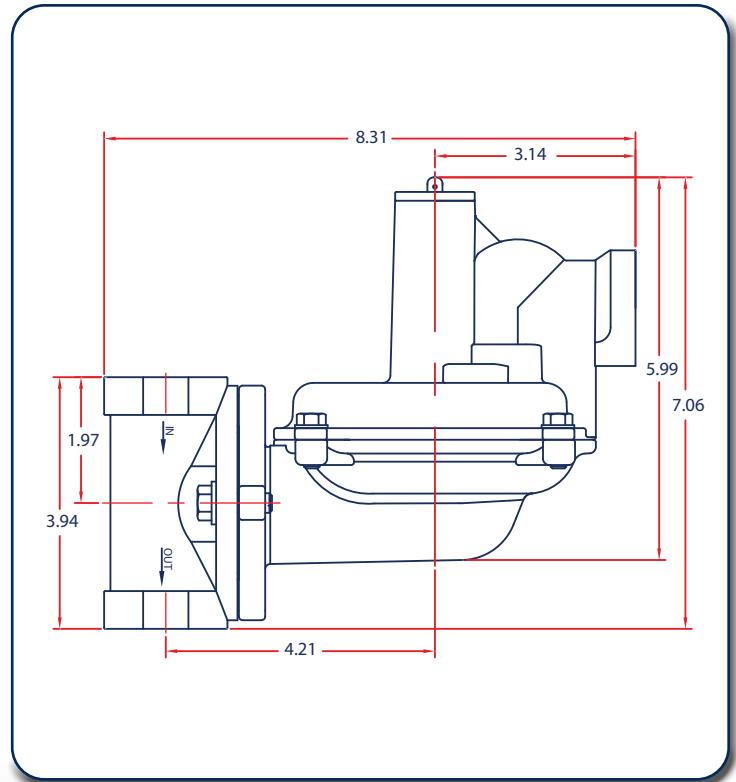

Notice:

When changing a lower pressure P140 to a higher pressure unit, the bonnet and adjustment screw must be change as well.

5"-7" up to 1-2 psi spring ranges use;
Bonnet 604-291-000 Adjust 648-581-000

2-4 psi up to 4-5 psi spring ranges use;
Bonnet 604-292-000 Adjust 648-581-001

P133 Pressure Regulator

- Suitable for Monitoring
- Balanced Supply Valve
- Wide Pressure Range Offering

The P133 is a direct operated pressure reducing regulator with external pressure registration used in commercial and industrial applications such as furnaces and burners where accuracy and sensitivity is critical. The regulator utilizes a balanced diaphragm design that provides for the sensitivity and accuracy. This minimizes the effects of supply pressure variation on output pressure. The P133 is available in low pressure or high pressure models and a broad range of outlet spring ranges. The P133 is also suitable in pressure monitoring applications.

Applications

- Industrial and Commercial Gas Regulation
- Compressors
- Gas Engines
- Natural Gas and Propane Applications



Materials of Construction

Adjusting Screw	Aluminum, Brass or Steel
Body	Ductile Cast Iron or WCB Steel
Bonnet	Aluminum or Cast Iron
Cage	Aluminum
Diaphragm	Nitrile or Fluorocarbon
Lower Casing	Aluminum or Steel
Molded Seat Assembly	Nitrile or Fluorocarbon
Orifice	Aluminum
Upper Casing	Steel

P133 Wide Open Flow Coefficients

Capacity	Wide Open C_g for Relief Valve Sizing	Representative C_1
25% ⁽¹⁾	490	28.2
40% ⁽¹⁾	760	29.1
60% ⁽¹⁾	1150	31.8
100%	1800	35.0

1. Using optional restriction collar.
2. $C_1 = C_g / C_v$

Specifications

	133L	133H	133K
Maximum Operating Inlet	60 PSIG	60 PSIG	150 PSIG
Maximum Emergency Inlet	125 PSIG	125 PSIG	150 PSIG
Maximum Operating Outlet	2 PSIG	10 PSIG	Set + 40 PSIG
Maximum Emergency Outlet	15 PSIG	15 PSIG	150 PSIG
Pressure Ranges	See Table 2		
Port Sizes	2 NPT		
Restrictor Collars	25%		
	40%		
	60%		
End Connections	2" NPT (Standard)		
	125 FF Flange (Iron Only)		
	150 RF Flange (Steel Only)		
Temperature Range	-40°F to 200°F		
	-40°C to 93°C		
Approx. Weight	35 lbs. (15.9 kg)		60 lbs. (27.2 kg)

P133 Series Range Springs

Model	Spring Ranges		Spring Color	Part Number
	WC or PSIG	mBAR		
P133 L & P133 H	2" - 4" WC	4.98-19.92	Brown	655-697-002
	3.5" - 6" WC	8.71-14.94	Pink	655-730-002
	5" - 9" WC	12.45-22.41	Tan	655-730-003
	6" - 14" WC	14.94-34.87	Purple	655-697-011
	8.5" - 18" WC	21.17-44.83	White	655-697-005
	14" - 28" WC	34.87-69.74	Green	655-697-006
	0.75 - 2 PSIG	51.71-137.89	Dark Blue	655-697-007
P133 H	PSIG	BAR		
	1.5 - 3.25 PSIG	0.103 - 0.224	Orange	655-697-008
	2 - 5 PSIG	0.138 - 0.345	Yellow	655-730-000
	5 - 10 PSIG	0.345 - 0.689	Grey	655-730-001
P133K	6 - 20 PSIG	0.413 - 1.378	Silver	655-771-002
	16 - 30 PSIG	1.103 - 2.068	Red	655-771-003
	26 - 40 PSIG	1.792 - 2.757	Blue	655-771-004
	36 - 50 PSIG	2.482 - 3.447	Green	655-771-005
	45 - 60 PSIG	3.102 - 4.136	White	655-771-006
	2 - 5 PSIG	0.137 - 0.344	Yellow	655-771-000
	4.5 - 10 PSIG	0.310 - 0.689	Orange	655-771-001

P133 Part Matrix

P133 Regulator Rebuild Kits

	Kit Includes	Part Number
P133 L Version	Nitrile - Kits Includes: Diaphragm (2), valve disk assembly, orifice, orifice O-ring, upper stem O-ring (2), body O-ring, sealing washers (2), bearing, guide washer and cap gasket and thrust washer	971-P13-302
	Fluorocarbon - Kits Includes: Diaphragm (2), valve disk assembly, orifice, orifice O-ring, upper stem O-ring (2), body O-ring, sealing washers (2), bearing, guide washer, cap gasket and thrust washer	971-P13-303
P133 H Version	Nitrile -- Kits Includes: Diaphragm (2), valve disk assembly, orifice, orifice O-ring, upper stem O-ring (2), body O-ring, sealing washers (2), bearing, guide washer and cap gasket and thrust washer	971-P13-300
	Fluorocarbon - Kits Includes: Diaphragm (2), valve disk assembly, orifice, orifice O-ring, upper stem O-ring (2), body O-ring, sealing washers (2), bearing, guide washer, cap gasket and thrust washer	971-P13-301
P133 K Version	Nitrile - Kits Includes: Diaphragm (2), valve disk assembly, orifice, orifice O-ring, upper stem O-ring (2), body O-ring, sealing washers (2), bearing, guide washer and cap gasket and thrust washer, adaptor O-ring, diaphragm O-ring, mounting bracket gasket	971-P13-304
	Fluorocarbon - Kits Includes: Diaphragm (2), valve disk assembly, orifice, orifice O-ring, upper stem O-ring (2), body O-ring, sealing washers (2), bearing, guide washer and cap gasket and thrust washer, adaptor O-ring, diaphragm O-ring, mounting bracket gasket	971-P13-305

P133						Version
▲	▲	▲	▲	▲	▲	Low Pressure
L						High Pressure
H						Heavy Pressure
K						Main Spring
						WC or PSIG mBAR
					004	2" - 4" WC 4.98 - 19.92
					006	3.5" - 6" WC 8.71 - 14.94
					009	5" - 9" WC 12.45 - 22.41
					014	6" - 14" WC 14.94 - 34.87
					018	8.5" - 18" WC 21.17 - 44.83
					028	14" - 28" WC 34.87 - 69.74
					002	0.75 - 2 PSIG 51.71 - 137.89
						PSIG BAR
					003	1.5 - 3.25 PSIG 0.103 - 0.224
					005	2 - 5 PSIG 0.137 - 0.344
					010	5 - 10 PSIG 0.345 - 0.689
					020	6 - 20 PSIG 0.413 - 1.378
					030	16 - 30 PSIG 1.103 - 2.068
					040	26 - 40 PSIG 1.792 - 2.757
					050	36 - 50 PSIG 2.482 - 3.447
					060	45 - 60 PSIG 3.102 - 4.136
					K05	2 - 5 PSIG 0.137 - 0.344
					K10	4.5 - 10 PSIG 0.310 - 0.689
						Special Construction
					O	None
					A	150 RF (2" Steel Only)
					E	125 FF (2" Iron Only)
						Restriction
					00	None
					25	25%
					40	40%
					60	60%
						Port Orientation
					1	Up (Standard)
					2	Down
					3	Right
					4	Left
						Bonnet Orientation
					C	12 O'Clock
					D	3 O'Clock
					E	6 O'Clock (Standard)
					F	9 O'Clock
						Trim Material
					0	Nitrile
					2	Fluorocarbon
						Body Material
					0	Iron
					2	Steel

P133 Port Orientation

PORT ORIENTATION (ORDERING MATRIX DIGIT "12")

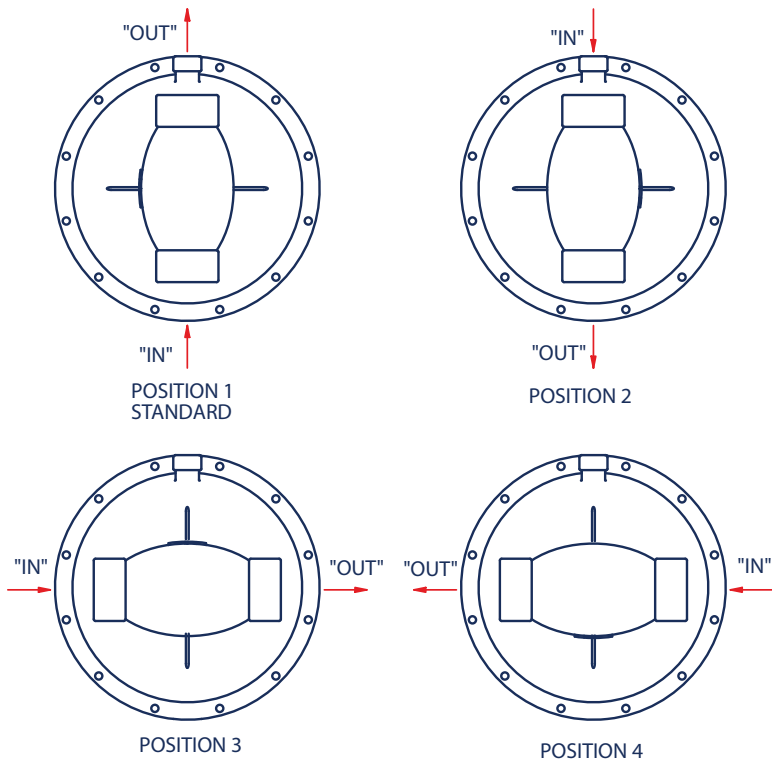

Port orientation is based on the body's 'Out' port location in relation to the control port of the housing.

P133 Bonnet Vent Orientation

BONNET VENT ORIENTATION (ORDERING MATRIX DIGIT "13")

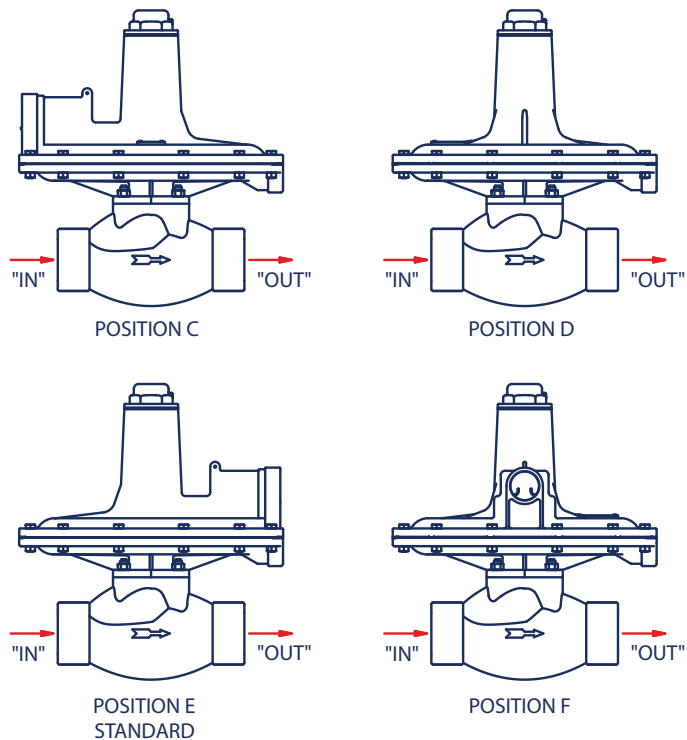

P133 Dimensions

	Body Type	A			B	C	D		
		2" NPT	125 FF	150 RF			2" NPT	125 FF	150 RF
H & L	Standard	10.0	—	—	7.91	13.36	4.36	—	—
	Flanged	—	10.0	10.0	7.91	13.36	—	4.36	4.36

P133 Standard

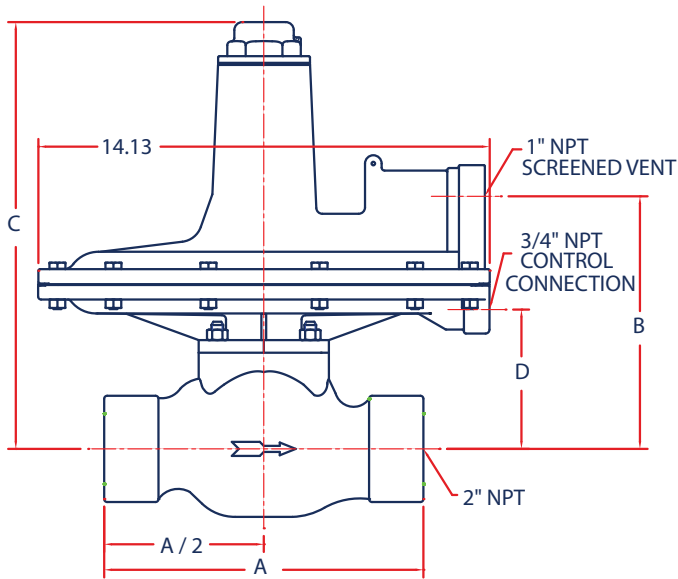

P133 Flanged

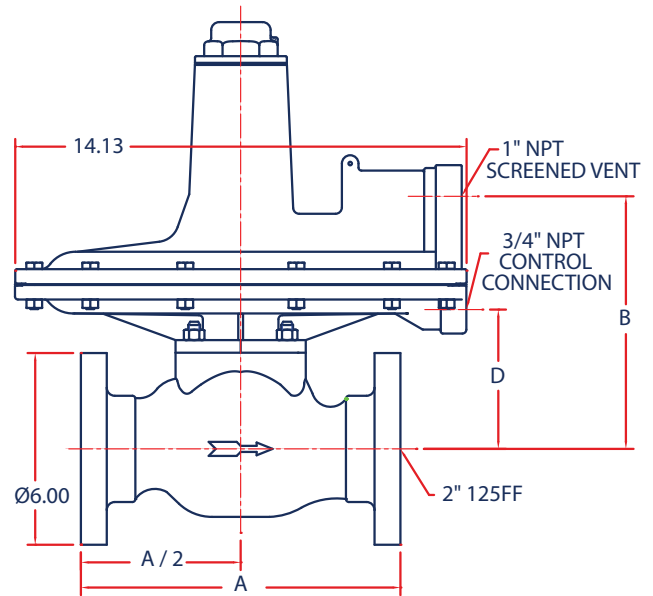

P133K

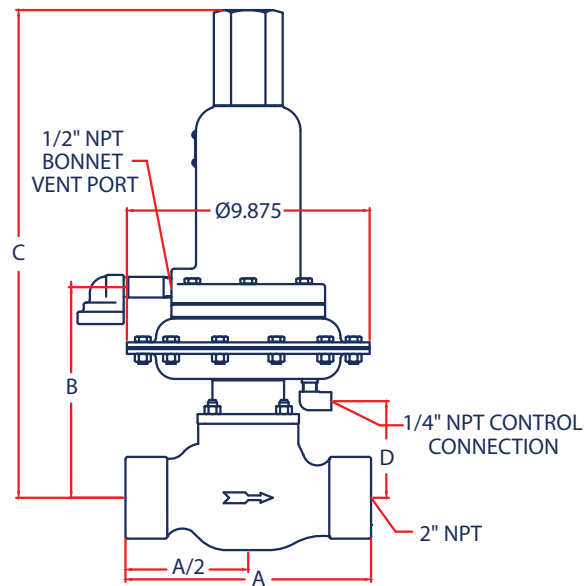

P133L Unrestricted Flow Capacities in Thousands of SCFH

(Nm³/h) of 0.6 Specific Gravity Natural Gas at 14.7 PSIA and 60°F

Inlet Pressure		Outlet Pressure Setting ⁽¹⁾ and Outlet Pressure Range													
		4 in. WC (10 mBAR) 2 to 4 in. WC (5 to 10 mBAR)		6 in. WC (15 mBAR) 3.5 to 6 in. WC (8.7 to 15 mBAR)		7 in. WC (17 mBAR) 5 to 9 in. WC (12 to 22 mBAR)		14 in. WC (35 mBAR) 8.5 to 18 in. WC (21.2 to 44.8 mBAR)		14 in. WC (35 mBAR) 14 to 28 in. WC (35 to 70 mBAR)		1 PSIG (0.07 BAR) 14 to 28 in. WC (35 to 70 mBAR)		2 PSIG (0.14 BAR) 0.75 to 2 PSIG (0.05 to 0.14 BAR)	
		1 in. WC (2.5 mBAR) Droop	1 in. WC (2.5 mBAR) Droop	1 in. WC (2.5 mBAR) Droop	1 in. WC (2.5 mBAR) Droop	2 in. WC (5 mBAR) Droop	1 in. WC (2.5 mBAR) Droop	2 in. WC (5 mBAR) Droop	10% Droop	20% Droop	10% Droop	20% Droop			
PSIG	BAR														
1	0.07	14 (0.38)	13 (0.35)	12 (0.32)	5 (0.13)	8.4 (0.22)									
2	0.14	20.8 (0.56)	20 (0.54)	17 (0.46)	8.2 (0.22)	15.2 (0.41)				11.5 (0.31)	16 (0.43)				
3	0.21	26 (0.70)	24.5 (0.66)	21 (0.56)	12 (0.32)	19.5 (0.52)				15.5 (0.42)	21.5 (0.58)	12.5 (0.34)	18.5 (0.50)		
5	0.34	35 (0.94)	33 (0.88)	32 (0.86)	16 (0.43)	28 (0.75)	14 (0.38)	23 (0.62)	24 (0.64)	31.5 (0.84)	20.5 (0.55)	28 (0.75)			
10	0.69	52 (1.39)	52 (1.39)	48 (1.29)	34 (0.91)	45 (1.21)	26 (0.70)	38 (1.02)	37.5 (1.00)	44 (1.18)	38 (1.02)	46 (1.29)			
20	1.38	78 (2.09)	77 (2.06)	79 (2.12)	69 (1.85)	76 (2.04)	60 (1.61)	69 (1.85)	70 (1.88)	77 (2.06)	62 (1.66)	76 (2.04)			
30	2.07	101 (2.7)	100 (2.68)	100 (2.68)	91 (2.44)	97 (2.60)	87 (2.33)	93 (2.49)	90 (2.41)	101 (2.71)	87 (2.33)	101 (2.71)			
40	2.76	124 (3.32)	122 (3.27)	124 (3.32)	109 (2.92)	116 (3.11)	107 (2.87)	115 (3.08)	110 (2.95)	122 (3.27)	105 (2.81)	121 (3.24)			
50	3.45	146 (3.91)	144 (3.86)	145 (3.89)	130 (3.48)	136 (3.64)	132 (3.54)	137 (3.67)	127 (3.40)	145 (3.89)	124 (3.32)	145 (3.89)			
60	4.14	170 (4.56)	168 (4.50)	166 (4.45)	155 (4.15)	161 (4.32)	152 (4.07)	158 (4.23)	149 (3.99)	167 (4.48)	145 (3.89)	170 (4.56)			

P133H Unrestricted Flow Capacities in Thousands of SCFH

(Nm³/h) of 0.6 Specific Gravity Natural Gas at 14.7 Psia and 60°F

Inlet Pressure		Outlet Pressure Setting ⁽¹⁾ and Outlet Pressure Range												
		3 PSIG (0.21 BAR) 1.5 to 3 PSIG (0.10 to 0.21 BAR)		2 PSIG (0.14 BAR) 2 to 5 PSIG (0.14 to 0.34 BAR)		5 PSIG (0.34 BAR) 2 to 5 PSIG (0.14 to 0.34 BAR)		5 PSIG (0.34 BAR) 5 to 10 PSIG (0.34 to 0.69 BAR)		10 PSIG (0.69 BAR) 5 to 10 PSIG (0.34 to 0.69 BAR)				
		10% Droop	20% Droop	10% Droop	20% Droop	10% Droop	20% Droop	10% Droop	20% Droop	10% Droop	20% Droop			
PSIG	BAR													
3	0.21			6.5 (0.17)	11.5 (0.31)									
5	0.34	14 (0.38)	22 (0.59)	11 (0.30)	18 (0.48)									
7	0.48	21.5 (0.58)	31 (0.83)	13 (0.35)	22 (0.59)	15.5 (0.42)	24 (0.64)	9 (0.24)	15 (0.40)					
10	0.69	28 (0.75)	42 (1.13)	15 (0.40)	27 (0.72)	24 (0.64)	35 (0.94)	14 (0.38)	22 (0.59)					
15	1.03	40 (1.07)	57 (1.53)	25.5 (0.68)	39 (1.04)	35 (0.94)	51 (1.37)	19 (0.51)	31.5 (0.84)	21 (0.56)	35 (0.94)			
20	1.38	52 (1.39)	72 (1.93)	35 (0.94)	52 (1.39)	46 (1.23)	67 (1.80)	24 (0.64)	41 (1.10)	31 (0.83)	51 (1.37)			
30	2.07	76 (2.04)	96 (2.57)	49 (1.31)	73 (1.96)	68 (1.82)	95 (2.55)	35 (0.94)	58 (1.55)	44 (1.18)	74 (1.98)			
40	2.76	98 (2.63)	119 (3.19)	66 (1.77)	97 (2.60)	88 (2.36)	117 (3.14)	44 (1.18)	73 (1.96)	56 (1.50)	97 (2.60)			
50	3.44	118 (3.16)	141 (3.78)	84 (2.25)	112 (3.00)	103 (2.76)	138 (3.70)	57 (1.53)	89 (2.38)	74 (1.98)	117 (3.14)			
60	4.14	136 (3.64)	165 (4.42)	104 (2.79)	132 (3.54)	122 (3.27)	156 (4.18)	65 (1.74)	106 (2.84)	91 (2.44)	136 (3.64)			

1. Outlet pressure setting was made at approximately 10% of the maximum capacity for the listed conditions.

P133H Flow Capacities in Thousands of SCFH

(Nm³/h) of 0.6 Specific Gravity Natural Gas at 14.7 Psia and 60°F

Inlet Pressure		Outlet Pressure Setting ⁽¹⁾ and Outlet Pressure Range											
		25% Capacity				40% Capacity				60% Capacity			
		5 PSIG (0.34 BAR) 2 to 5 PSIG (0.14 to 0.34 BAR)		10 PSIG (0.69 BAR) 5 to 10 PSIG (0.34 to 0.69 BAR)		5 PSIG (0.34 BAR) 2 to 5 PSIG (0.14 to 0.34 BAR)		10 PSIG (0.69 BAR) 5 to 10 PSIG (0.34 to 0.69 BAR)		5 PSIG (0.34 BAR) 2 to 5 PSIG (0.14 to 0.34 BAR)		10 PSIG (0.69 BAR) 5 to 10 PSIG (0.34 to 0.69 BAR)	
PSIG	BAR	10% Droop	20% Droop	10% Droop	20% Droop	10% Droop	20% Droop	10% Droop	20% Droop	10% Droop	20% Droop	10% Droop	20% Droop
7	0.48	8.0 (0.21)	9.0 (0.24)			11.0 (0.0)	15.0 (0.40)			13.0 (0.35)	17.0 (0.46)		
10	0.69	12.3 (0.33)	13.0 (0.35)			16.5 (0.44)	20.0 (0.54)			20.0 (0.54)	25.0 (0.67)		
15	1.03			13.0 (0.35)	15.5 (0.42)			16.5 (0.44)	23.5 (0.63)			20.0 (0.54)	29.5 (0.79)
20	1.38	20.8 (0.56)	21.2 (0.57)	17.5 (0.47)	20.0 (0.54)	31.5 (0.84)	33.5 (0.90)	23.5 (0.63)	30.5 (0.82)	36.0 (0.96)	46.5 (1.25)	29.0 (0.78)	39.5 (1.06)
40	2.76	33.5 (0.90)	33.5 (0.90)	33.0 (0.88)	33.5 (0.90)	52.0 (1.39)	53.2 (1.43)	46.0 (1.23)	53.2 (1.43)	70.0 (1.88)	77.5 (2.08)	57.0 (1.53)	74.5 (2.00)
60	4.14	45.5 (1.22)	45.5 (1.22)	45.5 (1.22)	45.5 (1.22)	72.7 (1.95)	72.7 (1.95)	67.0 (1.80)	72.7 (1.95)	105.0 (2.81)	107.0 (2.87)	87.0 (2.33)	107 (2.87)

1. Outlet pressure setting was made at approximately 10% of the maximum capacity for the listed conditions.

P133K Regulator 100% Capacities in Thousands of SCFH of (0.6 Specific Gravity Gas)

Outlet Pressure Range, Control Spring Number and Color	Outlet Pressure Setting ¹		Inlet Pressure		2" (DN 50) Body Size		
					1.91 Inches (48.5 mm) Orifice Size		
					Droop from Setpoint		
PSIG	BAR	PSIG	BAR	10%	20%	30%	
				SCFH (Nm3/h)	SCFH (Nm3/h)	SCFH (Nm3/h)	
2 to 5 PSIG 0.14 to 0.34 BAR 655-771-000 Yellow	2	0.14	10	0.7	10.4 (0.28)	18.9 (0.51)	27.5 (0.74)
			20	1.4	16.4 (0.44)	29.8 (0.80)	43.3 (1.16)
			40	2.8	27.0 (0.72)	49.1 (1.32)	71.2 (1.91)
			60	4.1	37.1 (0.99)	67.5 (1.81)	97.9 (2.62)
			80	5.5	47.2 (1.26)	85.7 (2.30)	124.3 (3.33)
			100	6.9	57.1 (1.53)	103.9 (2.78)	150.6 (4.04)
			125	8.6	69.5 (1.86)	126.5 (3.39)	183.4 (4.92)
	150	10.3	82.0 (2.20)	149.1 (4.00)	216.3 (5.80)		
	5	0.34	10	0.7	20.2 (0.54)	41.5 (1.11)	42.8 (1.15)
			20	1.4	35.1 (0.94)	71.7 (1.92)	72.3 (1.94)
			40	2.8	59.6 (1.60)	121.3 (3.25)	121.5 (3.26)
			60	4.1	82.4 (2.21)	167.9 (4.50)	168.0 (4.50)
			80	5.5	104.9 (2.81)	213.6 (5.72)	213.6 (5.72)
			100	6.9	127.2 (3.41)	258.9 (6.94)	258.9 (6.94)
125			8.6	155.0 (4.15)	315.4 (8.45)	315.4 (8.45)	
4.5 to 10 PSIG 0.31 to 0.69 BAR 655-771-001 Orange	5	0.34	10	0.7	11.4 (0.31)	21.4 (0.57)	32.0 (0.86)
			20	1.4	19.6 (0.52)	36.4 (0.98)	53.4 (1.43)
			40	2.8	33.0 (0.88)	61.3 (1.64)	89.6 (2.40)
			60	4.1	45.7 (1.22)	84.7 (2.27)	123.7 (3.32)
			80	5.5	58.1 (1.56)	107.7 (2.89)	157.3 (4.22)
			100	6.9	70.5 (1.89)	130.6 (3.50)	190.7 (5.11)
			125	8.6	85.8 (2.30)	159.0 (4.26)	232.2 (6.22)
	150	10.3	101.2 (2.71)	187.5 (5.02)	273.8 (7.34)		
	10	0.69	25	1.7	40.3 (1.08)	80.5 (2.16)	81.7 (2.19)
			30	2.7	47.1 (1.26)	93.9 (2.52)	94.8 (2.54)
			40	2.8	59.9 (1.60)	119.1 (3.19)	119.7 (3.21)
			60	4.1	84.0 (2.25)	166.8 (4.47)	167.1 (4.48)
			80	5.5	107.4 (2.88)	213.0 (5.71)	213.2 (5.71)
			100	6.9	130.4 (3.50)	258.7 (6.93)	258.8 (6.94)
125			8.6	159.0 (4.26)	315.4 (8.45)	315.4 (8.45)	
6 to 20 PSIG 0.41 to 1.4 BAR 655-771-002 Silver	10	0.69	15	1.0	16.4 (0.44)	32.0 (0.86)	51.9 (1.39)
			20	1.4	22.1 (0.59)	42.2 (1.13)	67.7 (1.81)
			40	2.8	39.9 (1.07)	75.4 (2.02)	111.0 (2.98)
			60	4.1	55.9 (1.50)	105.0 (2.81)	155.0 (4.15)
			80	5.5	71.4 (1.91)	134.0 (3.59)	198.0 (5.31)
			100	6.9	86.8 (2.33)	163.0 (4.37)	240.0 (6.43)
			125	8.6	106.0 (2.84)	199.0 (5.33)	292.0 (7.83)
	150	10.3	125.0 (3.35)	235.0 (6.30)	344.0 (9.22)		
	20	1.38	25	1.7	38.8 (1.39)	65.0 (1.74)	70.0 (1.88)
			20	2.1	50.3 (1.81)	82.3 (2.21)	86.0 (2.30)
			40	2.8	69.4 (2.98)	112.0 (3.00)	114.0 (3.06)
			60	4.1	102.0 (4.15)	163.0 (4.37)	164.0 (4.40)
			80	5.5	133.0 (5.31)	211.0 (5.66)	211.0 (5.66)
			100	6.9	162.0 (6.43)	257.0 (6.89)	258.0 (6.91)
125			8.6	198.0 (7.83)	315.0 (8.44)	315.0 (8.44)	
150	10.3	234.0 (9.22)	372.0 (9.97)	372.0 (9.97)			

1. Outlet pressure setting was made at approximately 10% of the maximum capacity for the listed conditions.
 - Gray areas indicate maximum flow capacity.

Outlet Pressure Range, Control Spring Number and Color	Outlet Pressure Setting ¹		Inlet Pressure		2" (DN 50) Body Size		
					1.91 Inches (48.5 mm) Orifice Size		
					Droop from Setpoint		
PSIG	BAR	PSIG	BAR	10%	20%	30%	
				SCFH (Nm3/h)	SCFH (Nm3/h)	SCFH (Nm3/h)	
16 to 30 PSIG 1.1 to 2.1 BAR 655-771-003 Red	20	1.38	25	1.7	24.8 (0.66)	50.4 (1.35)	70.0 (1.88)
			30	2.1	31.8 (0.85)	62.6 (1.68)	86.0 (2.30)
			40	2.8	43.5 (1.17)	84.0 (2.25)	114.0 (3.06)
			60	4.1	63.8 (1.71)	122.0 (3.27)	164.0 (4.40)
			80	5.5	83.0 (2.22)	158.0 (4.23)	211.0 (5.66)
			100	6.9	101.0 (2.71)	192.0 (5.15)	258.0 (6.91)
			125	8.6	124.0 (3.23)	235.0 (6.30)	315.0 (8.44)
	150	10.3	146.0 (3.91)	277.0 (7.42)	372.0 (9.97)		
	30	2.07	35	2.4	43.0 (1.15)	80.6 (2.16)	88.2 (2.36)
			40	2.8	53.8 (1.44)	98.4 (2.64)	104.0 (2.79)
			60	4.1	88.0 (2.36)	156.0 (4.18)	159.0 (4.26)
			80	5.5	117.0 (3.14)	207.0 (5.55)	208.0 (5.57)
			100	6.9	145.0 (3.89)	255.0 (6.83)	256.0 (6.86)
			125	8.6	178.0 (4.77)	313.0 (8.39)	314.0 (8.42)
150			10.3	211.0 (5.66)	371.0 (9.94)	371.0 (9.94)	
26 to 40 PSIG 1.8 to 2.8 BAR 655-771-004 Blue	30	2.1	35	2.4	28.9 (0.78)	59.6 (1.60)	88.2 (2.36)
			40	2.8	35.7 (0.96)	71.0 (1.90)	104.0 (2.79)
			60	4.1	57.5 (1.54)	110.0 (2.95)	159.0 (4.26)
			80	5.5	76.4 (2.05)	146.0 (3.91)	208.0 (5.57)
			100	6.9	94.3 (2.53)	179.0 (4.80)	256.0 (6.86)
			125	8.6	116.0 (3.11)	220.0 (5.90)	314.0 (8.42)
			150	10.3	137.0 (3.67)	260.0 (6.97)	371.0 (9.94)
	40	2.8	45	3.1	43.5 (1.17)	96.2 (2.58)	106.0 (2.84)
			50	3.4	52.6 (1.41)	114.0 (3.06)	122.0 (3.27)
			60	4.1	68.4 (1.83)	146.0 (3.91)	151.0 (4.05)
			80	5.5	95.4 (2.56)	186.0 (4.98)	204.0 (5.47)
			100	6.9	120.0 (3.22)	232.0 (6.22)	253.0 (6.78)
			125	8.6	149.0 (3.99)	287.0 (7.69)	312.0 (8.36)
			150	10.3	177.0 (4.74)	341.0 (9.14)	370.0 (9.92)
36 to 50 PSIG 2.5 to 3.4 BAR 655-771-005 Green	40	2.8	45	3.1	36.2 (0.97)	76.1 (2.04)	106.0 (2.84)
			50	3.4	43.4 (1.16)	88.1 (2.36)	122.0 (3.27)
			60	4.1	56.2 (1.51)	110.0 (2.95)	151.0 (4.05)
			80	5.5	78.1 (2.09)	150.0 (4.02)	204.0 (5.47)
			100	6.9	97.9 (2.62)	187.0 (5.01)	253.0 (6.78)
			125	8.6	122.0 (3.27)	232.0 (6.22)	312.0 (8.36)
			150	10.3	145.0 (3.89)	276.0 (7.40)	370.0 (9.92)
	50	3.4	55	3.8	50.4 (1.35)	112.0 (3.00)	124.0 (3.32)
			60	4.1	59.5 (1.60)	130.0 (3.48)	141.0 (3.78)
			80	5.5	90.2 (2.42)	191.0 (5.12)	197.0 (5.28)
			100	6.9	116.0 (3.11)	227.0 (6.08)	248.0 (6.65)
			125	8.6	147.0 (3.94)	283.0 (7.58)	309.0 (8.28)
			150	10.3	176.0 (4.72)	338.0 (9.06)	368.0 (9.86)
			45 to 60 PSIG 3.1 to 4.1 BAR 655-771-006 White	50	3.4	55	3.8
60	4.1	51.0 (1.37)				105.0 (2.81)	141.0 (3.78)
80	5.5	76.9 (2.06)				151.0 (4.05)	197.0 (5.28)
100	6.9	99.0 (2.65)				191.0 (5.12)	248.0 (6.65)
125	8.6	125.0 (3.35)				239.0 (6.40)	309.0 (8.28)
150	10.3	149.0 (3.99)				285.0 (7.64)	368.0 (9.86)
60	4.1	65				4.5	57.5 (1.54)
		70		4.8	66.5 (1.78)	146.0 (3.91)	159.0 (4.26)
		80		5.5	83.2 (2.23)	179.0 (4.80)	188.0 (5.04)
		100		6.9	112.0 (3.00)	236.0 (6.32)	242.0 (6.49)
		125		8.6	144.0 (3.86)	280.0 (7.50)	305.0 (8.17)
		150		10.3	174.0 (4.66)	336.0 (9.00)	365.0 (9.78)

1. Outlet pressure setting was made at approximately 10% of the maximum capacity for the listed conditions.
 - Gray areas indicate maximum flow capacity.

P133K Regulator 25% Capacities in Thousands of SCFH of (0.6 Specific Gravity Gas)

Outlet Pressure Range, Control Spring Number and Color	Outlet Pressure Setting ¹		Inlet Pressure		2" (DN 50) Body Size		
					1.91 Inches (48.5 mm) Orifice Size		
					Droop from Setpoint		
PSIG	BAR	PSIG	BAR	10%	20%	30%	
				SCFH (Nm ³ /h)	SCFH (Nm ³ /h)	SCFH (Nm ³ /h)	
2 to 5 PSIG 0.14 to 0.34 BAR 655-771-000 Yellow	2	0.14	10	0.7	4.0 (0.11)	7.8 (0.21)	13.4 (0.36)
			20	1.4	6.4 (0.17)	12.5 (0.34)	12.2 (0.33)
			40	2.8	10.5 (0.28)	20.6 (0.55)	34.9 (0.94)
			60	4.1	14.5 (0.39)	28.4 (0.76)	48.1 (1.29)
			80	5.5	18.4 (0.49)	36.0 (0.97)	61.1 (1.64)
			100	6.9	22.3 (0.60)	43.7 (1.17)	74.0 (1.98)
			125	8.6	27.2 (0.73)	53.2 (1.43)	90.1 (2.42)
	150	10.3	32.0 (0.86)	62.7 (1.68)	106.2 (2.85)		
	5	0.34	10	0.7	8.3 (0.22)	11.5 (0.31)	11.9 (0.32)
			20	1.4	14.9 (0.40)	20.3 (0.54)	20.5 (0.55)
			40	2.8	25.4 (0.68)	34.6 (0.93)	34.7 (0.93)
			60	4.1	35.2 (0.94)	47.9 (1.28)	48.0 (1.29)
			80	5.5	44.8 (1.20)	61.0 (1.64)	61.0 (1.64)
			100	6.9	54.3 (1.46)	74.0 (1.98)	74.0 (1.98)
125			8.6	66.2 (1.77)	90.1 (2.42)	90.1 (2.42)	
150	10.3	78.1 (2.09)	106.2 (2.85)	106.2 (2.85)			
4.5 to 10 PSIG 0.31 to 0.69 BAR 655-771-001 Orange	5	0.34	10	0.7	4.4 (0.12)	8.7 (0.23)	11.9 (0.32)
			20	1.4	7.8 (0.21)	15.4 (0.41)	20.5 (0.55)
			40	2.8	13.3 (0.36)	26.1 (0.70)	34.7 (0.93)
			60	4.1	18.4 (0.49)	36.2 (0.97)	48.0 (1.29)
			80	5.5	23.4 (0.63)	46.1 (1.24)	61.0 (1.64)
			100	6.9	28.4 (0.76)	55.9 (1.50)	74.0 (1.98)
			125	8.6	34.6 (0.93)	68.1 (1.83)	90.1 (2.42)
	150	10.3	40.8 (1.09)	80.2 (2.15)	106.2 (2.85)		
	10	0.69	25	1.7	17.0 (0.46)	22.6 (0.61)	23.0 (0.62)
			30	2.7	19.9 (0.53)	26.5 (0.71)	26.8 (0.72)
			40	2.8	25.5 (0.68)	33.8 (0.91)	34.0 (0.91)
			60	4.1	35.9 (0.96)	47.5 (1.27)	47.6 (1.28)
			80	5.5	45.9 (1.23)	60.8 (1.63)	60.9 (1.63)
			100	6.9	55.8 (1.50)	73.9 (1.98)	73.9 (1.98)
125			8.6	68.0 (1.82)	90.1 (2.42)	90.1 (2.42)	
150	10.3	80.2 (2.15)	106.2 (2.85)	106.2 (2.85)			
6 to 20 PSIG 0.41 to 1.4 BAR 655-771-002 Silver	10	0.69	15	1.0	6.3 (0.17)	13.3 (0.36)	14.1 (0.38)
			20	1.4	8.8 (0.24)	18.3 (0.49)	18.9 (0.51)
			40	2.8	16.4 (0.44)	33.8 (0.91)	34.0 (0.91)
			60	4.1	23.1 (0.62)	47.5 (1.27)	47.6 (1.28)
			80	5.5	29.5 (0.79)	60.8 (1.63)	60.9 (1.63)
			100	6.9	35.8 (0.96)	73.9 (1.98)	73.9 (1.98)
			125	8.6	43.7 (1.17)	90.1 (2.42)	90.1 (2.42)
	150	10.3	51.5 (1.38)	106.2 (2.85)	106.2 (2.85)		
	20	1.38	25	1.7	15.7 (0.42)	16.8 (0.45)	18.6 (0.50)
			20	2.1	21.6 (0.58)	22.3 (0.60)	23.5 (0.63)
			40	2.8	30.7 (0.82)	31.1 (0.83)	31.9 (0.86)
			60	4.1	45.9 (1.23)	46.1 (1.24)	46.5 (1.25)
			80	5.5	59.8 (1.60)	60.0 (1.61)	60.2 (1.61)
			100	6.9	73.3 (1.96)	73.4 (1.97)	73.5 (1.97)
125			8.6	89.8 (2.41)	89.8 (2.41)	89.9 (2.41)	
150	10.3	106.1 (2.84)	106.1 (2.84)	106.2 (2.85)			

1. Outlet pressure setting was made at approximately 10% of the maximum capacity for the listed conditions.
 - Gray areas indicate maximum flow capacity.

Outlet Pressure Range, Control Spring Number and Color	Outlet Pressure Setting ¹		Inlet Pressure		2" (DN 50) Body Size		
					1.91 Inches (48.5 mm) Orifice Size		
					Droop from Setpoint		
PSIG	BAR	PSIG	BAR	10%	20%	30%	
				SCFH (Nm ³ /h)	SCFH (Nm ³ /h)	SCFH (Nm ³ /h)	
16 to 30 PSIG 1.1 to 2.1 BAR 655-771-003 Red	20	1.38	25	1.7	9.2 (0.25)	16.8 (0.45)	18.6 (0.50)
			30	2.1	12.6 (0.34)	22.3 (0.60)	23.5 (0.63)
			40	2.8	17.8 (0.48)	31.1 (0.83)	31.9 (0.86)
			60	4.1	26.6 (0.71)	46.1 (1.24)	46.5 (1.25)
			80	5.5	34.6 (0.93)	60.0 (1.61)	60.2 (1.61)
			100	6.9	42.3 (1.13)	73.4 (1.97)	73.5 (1.97)
			125	8.6	51.9 (1.39)	89.8 (2.41)	89.9 (2.41)
	150	10.3	61.3 (1.64)	106.1 (2.84)	106.2 (2.85)		
	30	2.07	35	2.4	18.5 (0.50)	20.2 (0.54)	23.0 (0.62)
			40	2.8	21.5 (0.58)	26.1 (0.70)	28.1 (0.75)
			60	4.1	37.1 (0.99)	43.6 (1.17)	44.6 (1.20)
			80	5.5	50.0 (1.34)	58.4 (1.56)	59.0 (1.58)
			100	6.9	62.1 (1.66)	72.3 (1.94)	72.7 (1.95)
			125	8.6	76.6 (2.05)	89.2 (2.39)	89.4 (2.40)
150			10.3	90.9 (2.44)	105.7 (2.83)	105.9 (2.84)	
26 to 40 PSIG 1.8 to 2.8 BAR 655-771-004 Blue	30	2.1	35	2.4	10.3 (0.28)	20.2 (0.54)	23.0 (0.62)
			40	2.8	13.6 (0.36)	26.1 (0.70)	28.1 (0.75)
			60	4.1	23.4 (0.63)	43.6 (1.17)	44.6 (1.20)
			80	5.5	31.6 (0.85)	58.4 (1.56)	59.0 (1.58)
			100	6.9	39.1 (1.05)	72.3 (1.94)	72.7 (1.95)
			125	8.6	48.3 (1.29)	89.2 (2.39)	89.4 (2.40)
			150	10.3	57.3 (1.54)	105.7 (2.83)	105.9 (2.84)
	40	2.8	45	3.1	15.5 (0.42)	23.7 (0.64)	27.5 (0.74)
			50	3.4	20.3 (0.54)	29.7 (0.80)	32.7 (0.88)
			60	4.1	27.8 (0.74)	39.6 (1.06)	41.6 (1.12)
			80	5.5	39.9 (1.07)	56.0 (1.50)	57.2 (1.53)
			100	6.9	50.6 (1.36)	70.7 (1.90)	71.5 (1.92)
			125	8.6	63.2 (1.69)	88.1 (2.36)	88.6 (2.37)
			150	10.3	75.4 (2.02)	105.0 (2.81)	105.4 (2.82)
36 to 50 PSIG 2.5 to 3.4 BAR 655-771-005 Green	40	2.8	45	3.1	12.5 (0.34)	23.7 (0.64)	27.5 (0.74)
			50	3.4	16.4 (0.44)	29.7 (0.80)	32.7 (0.88)
			60	4.1	22.4 (0.60)	39.6 (1.06)	41.6 (1.12)
			80	5.5	32.1 (0.86)	56.0 (1.50)	57.2 (1.53)
			100	6.9	40.7 (1.09)	70.7 (1.90)	71.5 (1.92)
			125	8.6	50.8 (1.36)	88.1 (2.36)	88.6 (2.37)
			150	10.3	60.6 (1.62)	105.0 (2.81)	105.4 (2.82)
	50	3.4	55	3.8	17.5 (0.47)	27.0 (0.72)	31.9 (0.86)
			60	4.1	22.5 (0.60)	33.3 (0.89)	37.2 (1.00)
			80	5.5	37.1 (0.99)	52.5 (1.41)	54.6 (1.46)
			100	6.9	48.7 (1.30)	68.4 (1.83)	69.8 (1.87)
			125	8.6	61.9 (1.66)	86.6 (2.32)	87.5 (2.34)
			150	10.3	74.5 (2.00)	103.9 (2.78)	104.5 (2.80)
			45 to 60 PSIG 3.1 to 4.1 BAR 655-771-006 White	50	3.4	55	3.8
60	4.1	18.9 (0.51)				33.3 (0.89)	37.2 (1.00)
80	5.5	31.1 (0.83)				52.5 (1.41)	54.6 (1.46)
100	6.9	40.9 (1.10)				68.4 (1.83)	69.8 (1.87)
125	8.6	52.0 (1.39)				86.6 (2.32)	87.5 (2.34)
150	10.3	62.5 (1.68)				103.9 (2.78)	104.5 (2.80)
60	4.1	65				4.5	19.5 (0.52)
		70		4.8	24.7 (0.66)	36.9 (0.99)	41.7 (1.12)
		80		5.5	33.1 (0.83)	47.6 (1.28)	51.1 (1.37)
		100		6.9	46.3 (1.24)	65.2 (1.75)	67.4 (1.81)
		125		8.6	60.4 (1.62)	84.5 (2.26)	85.9 (2.30)
		150		10.3	73.5 (1.97)	102.4 (2.74)	103.4 (2.77)

1. Outlet pressure setting was made at approximately 10% of the maximum capacity for the listed conditions.
 - Gray areas indicate maximum flow capacity.

P133K Regulator 40% Capacities in Thousands of SCFH of (0.6 Specific Gravity Gas)

Outlet Pressure Range, Control Spring Number and Color	Outlet Pressure Setting ¹		Inlet Pressure		2" (DN 50) Body Size 1.91 Inches (48.5 mm) Orifice Size		
					Droop from Setpoint		
					10%	20%	30%
PSIG	BAR	PSIG	BAR	SCFH (Nm3/h)	SCFH (Nm3/h)	SCFH (Nm3/h)	
2 to 5 PSIG 0.14 to 0.34 BAR 655-771-000 Yellow	2	0.14	10	0.7	6.9 (0.18)	13.2 (0.35)	19.7 (0.53)
			20	1.4	10.5 (0.28)	20.1 (0.54)	29.7 (0.80)
			40	2.8	16.6 (0.44)	31.9 (0.86)	47.2 (1.26)
			60	4.1	22.7 (0.61)	43.6 (1.17)	64.4 (1.73)
			80	5.5	28.8 (0.77)	55.2 (1.48)	81.7 (2.19)
			100	6.9	34.8 (0.93)	66.9 (1.79)	99.0 (2.65)
			125	8.6	42.4 (1.14)	81.5 (2.18)	120.5 (3.23)
	150	10.3	50.0 (1.34)	96.0 (2.57)	142.1 (3.81)		
	5	0.34	10	0.7	14.5 (0.39)	19.8 (0.53)	20.4 (0.55)
			20	1.4	24.4 (0.65)	32.8 (0.88)	32.9 (0.88)
			40	2.8	39.5 (1.06)	52.9 (1.42)	52.9 (1.42)
			60	4.1	54.0 (1.45)	72.3 (1.94)	72.3 (1.94)
			80	5.5	68.5 (1.84)	91.6 (2.46)	91.6 (2.46)
			100	6.9	82.9 (2.22)	111.0 (2.98)	111.0 (2.98)
			125	8.6	101.0 (2.71)	135.2 (3.62)	135.2 (3.62)
150			10.3	119.1 (3.19)	159.3 (4.27)	159.3 (4.27)	
4.5 to 10 PSIG 0.31 to 0.69 BAR 655-771-001 Orange	5	0.34	10	0.7	3.8 (0.10)	7.1 (0.19)	10.4 (0.28)
			20	1.4	5.8 (0.16)	10.7 (0.29)	15.7 (0.42)
			40	2.8	9.2 (0.25)	17.0 (0.46)	24.9 (0.67)
			60	4.1	12.5 (0.34)	23.3 (0.62)	34.0 (0.91)
			80	5.5	15.9 (0.43)	29.5 (0.79)	43.1 (1.16)
			100	6.9	19.3 (0.52)	35.7 (0.96)	52.2 (1.40)
			125	8.6	23.5 (0.63)	43.5 (1.17)	63.6 (1.70)
	150	10.3	27.7 (0.74)	51.3 (1.38)	75.0 (2.01)		
	10	0.69	25	1.7	28.2 (0.76)	37.0 (0.99)	37.4 (1.00)
			30	2.7	32.5 (0.87)	42.6 (1.14)	42.8 (1.15)
			40	2.8	40.5 (1.08)	52.9 (1.42)	52.9 (1.42)
			60	4.1	55.5 (1.49)	72.3 (1.94)	72.3 (1.94)
			80	5.5	70.4 (1.89)	91.6 (2.46)	91.6 (2.46)
			100	6.9	85.2 (2.28)	111.0 (2.98)	111.0 (2.98)
			125	8.6	103.8 (2.78)	135.2 (3.62)	135.2 (3.62)
150			10.3	122.4 (3.28)	159.3 (4.27)	159.3 (4.27)	
6 to 20 PSIG 0.41 to 1.4 BAR 655-771-002 Silver	10	0.69	15	1.0	11.3 (0.30)	23.6 (0.63)	24.7 (0.66)
			20	1.4	15.1 (0.40)	30.9 (0.83)	31.5 (0.84)
			40	2.8	26.3 (0.70)	52.9 (1.42)	52.9 (1.42)
			60	4.1	36.0 (0.96)	72.3 (1.94)	72.3 (1.94)
			80	5.5	45.6 (1.22)	91.6 (2.46)	91.6 (2.46)
			100	6.9	55.2 (1.48)	111.0 (2.98)	111.0 (2.98)
			125	8.6	67.3 (1.80)	135.2 (3.62)	135.2 (3.62)
	150	10.3	79.3 (2.12)	159.3 (4.27)	159.3 (4.27)		
	20	1.38	25	1.7	28.5 (0.76)	31.2 (0.84)	33.2 (0.89)
			20	2.1	37.1 (0.99)	38.8 (1.04)	40.1 (1.08)
			40	2.8	50.4 (1.35)	51.2 (1.37)	51.9 (1.39)
			60	4.1	72.0 (1.93)	72.2 (1.94)	72.3 (1.94)
			80	5.5	91.6 (2.46)	91.6 (2.46)	91.6 (2.46)
			100	6.9	111.0 (2.98)	111.0 (2.98)	111.0 (2.98)
			125	8.6	135.2 (3.62)	135.2 (3.62)	135.2 (3.62)
150			10.3	159.3 (4.27)	159.3 (4.27)	159.3 (4.27)	

1. Outlet pressure setting was made at approximately 10% of the maximum capacity for the listed conditions.
 - Gray areas indicate maximum flow capacity.

Outlet Pressure Range, Control Spring Number and Color	Outlet Pressure Setting ¹		Inlet Pressure		2" (DN 50) Body Size 1.91 Inches (48.5 mm) Orifice Size		
					Droop from Setpoint		
					10%	20%	30%
PSIG	BAR	PSIG	BAR	SCFH (Nm3/h)	SCFH (Nm3/h)	SCFH (Nm3/h)	
16 to 30 PSIG 1.1 to 2.1 BAR 655-771-003 Red	20	1.4	25	1.7	17.2 (0.46)	31.2 (0.84)	33.2 (0.89)
			30	2.1	22.1 (0.59)	38.8 (1.04)	40.1 (1.08)
			40	2.8	29.8 (0.80)	51.2 (1.37)	51.9 (1.39)
			60	4.1	42.5 (1.14)	72.2 (1.94)	72.3 (1.94)
			80	5.5	54.1 (1.45)	91.6 (2.46)	91.6 (2.46)
			100	6.9	65.5 (1.76)	111.0 (2.98)	111.0 (2.98)
			125	8.6	79.8 (2.14)	135.2 (3.62)	135.2 (3.62)
	30	2.07	150	10.3	94.0 (2.52)	159.3 (4.27)	159.3 (4.27)
			35	2.4	34.4 (0.92)	38.7 (1.04)	41.8 (1.12)
			40	2.8	38.4 (1.03)	46.6 (1.25)	48.8 (1.31)
			60	4.1	61.2 (1.64)	71.0 (1.90)	71.6 (1.92)
			80	5.5	79.7 (2.14)	91.5 (2.45)	91.6 (2.46)
			100	6.9	96.9 (2.60)	111.0 (2.98)	111.0 (2.98)
			125	8.6	118.0 (3.16)	135.2 (3.62)	135.2 (3.62)
			150	10.3	139.1 (3.73)	159.3 (4.27)	159.3 (4.27)
26 to 40 PSIG 1.8 to 2.8 BAR 655-771-004 Blue	30	2.1	35	2.4	19.7 (0.53)	38.7 (1.04)	41.8 (1.12)
			40	2.8	24.6 (0.66)	46.6 (1.25)	48.8 (1.31)
			60	4.1	39.0 (1.04)	71.0 (1.90)	71.6 (1.92)
			80	5.5	50.7 (1.36)	91.5 (2.45)	91.6 (2.46)
			100	6.9	61.6 (1.65)	111.0 (2.98)	111.0 (2.98)
			125	8.6	75.0 (2.01)	135.2 (3.62)	135.2 (3.62)
			150	10.3	88.4 (2.37)	159.3 (4.27)	159.3 (4.27)
	40	2.8	45	3.1	30.3 (0.81)	46.2 (1.24)	50.4 (1.35)
			50	3.4	37.1 (0.99)	54.3 (1.46)	57.4 (1.54)
			60	4.1	48.0 (1.29)	67.8 (1.82)	69.7 (1.87)
			80	5.5	65.6 (1.76)	90.5 (2.42)	91.2 (2.44)
			100	6.9	80.9 (2.17)	110.9 (2.97)	111.0 (2.98)
			125	8.6	98.9 (2.65)	135.2 (3.62)	135.2 (3.62)
			150	10.3	116.6 (3.12)	159.3 (4.27)	159.3 (4.27)
			45	3.1	24.6 (0.66)	46.2 (1.24)	50.4 (1.35)
36 to 50 PSIG 2.5 to 3.4 BAR 655-771-005 Green	40	2.8	50	3.4	30.0 (0.80)	54.3 (1.46)	57.4 (1.54)
			60	4.1	38.8 (1.04)	67.8 (1.82)	69.7 (1.87)
			80	5.5	52.9 (1.42)	90.5 (2.42)	91.2 (2.44)
			100	6.9	65.3 (1.75)	110.9 (2.97)	111.0 (2.98)
			125	8.6	79.8 (2.14)	135.2 (3.62)	135.2 (3.62)
			150	10.3	94.0 (2.52)	159.3 (4.27)	159.3 (4.27)
			55	3.8	34.8 (0.93)	53.7 (1.44)	59.0 (1.58)
	50	3.4	60	4.1	41.8 (1.12)	61.9 (1.66)	66.0 (1.77)
			80	5.5	62.9 (1.69)	88.1 (2.36)	89.8 (2.41)
			100	6.9	79.7 (2.14)	110.0 (2.95)	110.7 (2.97)
			125	8.6	98.7 (2.64)	135.2 (3.62)	135.2 (3.62)
			150	10.3	116.6 (3.12)	159.3 (4.27)	159.3 (4.27)
			55	3.8	29.5 (0.79)	53.7 (1.44)	59.0 (1.58)
			60	4.1	35.3 (0.95)	61.9 (1.66)	66.0 (1.77)
			80	5.5	53.0 (1.42)	88.1 (2.36)	89.8 (2.41)
45 to 60 PSIG 3.1 to 4.1 BAR 655-771-006 White	50	3.4	100	6.9	67.2 (1.80)	110.0 (2.95)	110.7 (2.97)
			125	8.6	83.1 (2.23)	135.2 (3.62)	135.2 (3.62)
			150	10.3	98.1 (2.63)	159.3 (4.27)	159.3 (4.27)
			65	4.5	39.5 (1.06)	61.3 (1.64)	67.6 (1.81)
			70	4.8	46.7 (1.25)	69.5 (1.86)	74.6 (2.00)
			80	5.5	58.6 (1.57)	83.8 (2.25)	87.2 (2.34)
			100	6.9	77.8 (2.08)	108.0 (2.89)	109.6 (2.94)
	60	4.1	125	8.6	98.1 (2.63)	134.6 (3.61)	135.1 (3.62)
			150	10.3	116.8 (3.13)	159.3 (4.27)	159.3 (4.27)

1. Outlet pressure setting was made at approximately 10% of the maximum capacity for the listed conditions.
 - Gray areas indicate maximum flow capacity.

P133K Regulator 60% Capacities in Thousands of SCFH of (0.6 Specific Gravity Gas)

Outlet Pressure Range, Control Spring Number and Color	Outlet Pressure Setting ¹		Inlet Pressure		2" (DN 50) Body Size		
					1.91 Inches (48.5 mm) Orifice Size		
					Droop from Setpoint		
PSIG	BAR	PSIG	BAR	10%	20%	30%	
				SCFH (Nm ³ /h)	SCFH (Nm ³ /h)	SCFH (Nm ³ /h)	
2 to 5 PSIG 0.14 to 0.34 BAR 655-771-000 Yellow	2	0.14	10	0.7	9.1 (0.24)	17.7 (0.47)	26.4 (0.71)
			20	1.4	14.5 (0.39)	28.3 (0.76)	42.1 (1.13)
			40	2.8	24.2 (0.65)	47.1 (1.26)	70.0 (1.88)
			60	4.1	33.5 (0.90)	65.2 (1.75)	96.9 (2.60)
			80	5.5	42.6 (1.14)	83.0 (2.22)	123.4 (3.31)
			100	6.9	51.8 (1.39)	100.8 (2.70)	149.8 (4.02)
			125	8.6	63.2 (1.69)	122.9 (3.29)	182.7 (4.90)
	150	10.3	74.5 (2.00)	145.0 (3.89)	215.6 (5.78)		
	5	0.34	10	0.7	18.8 (0.50)	26.1 (0.70)	27.0 (0.72)
			20	1.4	33.6 (0.90)	45.7 (1.22)	46.1 (1.24)
			40	2.8	57.8 (1.55)	78.4 (2.10)	78.5 (2.10)
			60	4.1	80.5 (2.16)	109.1 (2.92)	109.2 (2.93)
			80	5.5	102.9 (2.76)	139.4 (3.74)	139.4 (3.74)
			100	6.9	125.1 (3.35)	169.4 (4.54)	169.4 (4.54)
125			8.6	152.7 (4.09)	206.7 (5.54)	206.8 (5.54)	
4.5 to 10 PSIG 0.31 to 0.69 BAR 655-771-001 Orange	5	0.34	10	0.7	10.0 (0.27)	20.0 (0.54)	27.0 (0.72)
			20	1.4	17.7 (0.47)	34.8 (0.93)	46.1 (1.24)
			40	2.8	30.4 (0.82)	59.5 (1.60)	78.5 (2.10)
			60	4.1	42.3 (1.13)	82.9 (2.22)	109.2 (2.93)
			80	5.5	54.0 (1.45)	105.8 (2.84)	139.4 (3.74)
			100	6.9	65.7 (1.76)	128.6 (3.45)	169.4 (4.54)
			125	8.6	80.1 (2.15)	157.0 (4.21)	206.8 (5.54)
	150	10.3	94.6 (2.54)	185.2 (4.96)	244.0 (6.54)		
	10	0.69	25	1.7	38.3 (1.03)	51.2 (1.40)	52.1 (1.40)
			30	2.7	45.1 (1.21)	60.0 (1.63)	60.7 (1.63)
			40	2.8	57.8 (1.55)	76.6 (2.07)	77.1 (2.07)
			60	4.1	81.8 (2.19)	108.0 (2.90)	108.3 (2.90)
			80	5.5	105.1 (2.82)	138.6 (3.72)	138.8 (3.72)
			100	6.9	128.0 (3.43)	168.8 (4.53)	168.9 (4.53)
125			8.6	156.5 (4.19)	206.3 (5.53)	206.4 (5.53)	
6 to 20 PSIG 0.41 to 1.4 BAR 655-771-002 Silver	10	0.69	15	1.0	14.6 (0.39)	31.1 (0.83)	32.7 (0.88)
			20	1.4	20.0 (0.54)	41.8 (1.12)	42.9 (1.15)
			40	2.8	37.3 (1.00)	76.6 (2.05)	77.1 (2.07)
			60	4.1	52.7 (1.41)	108.0 (2.89)	108.3 (2.90)
			80	5.5	67.7 (1.81)	138.6 (3.71)	138.8 (3.72)
			100	6.9	82.5 (2.21)	168.8 (4.52)	168.9 (4.53)
			125	8.6	100.8 (2.70)	206.3 (5.53)	206.4 (5.53)
	150	10.3	119.1 (3.19)	243.7 (6.53)	243.8 (6.53)		
	20	1.38	25	1.7	36.9 (0.99)	40.9 (1.10)	44.2 (1.18)
			20	2.1	49.2 (1.32)	52.0 (1.39)	54.5 (1.46)
			40	2.8	69.2 (1.86)	71.1 (1.90)	72.7 (1.95)
			60	4.1	103.6 (2.78)	104.7 (2.81)	105.7 (2.83)
			80	5.5	135.5 (3.63)	136.3 (3.65)	136.9 (3.67)
			100	6.9	166.5 (4.46)	167.0 (4.48)	167.6 (4.49)
125			8.6	204.6 (5.48)	205.0 (5.49)	205.4 (5.50)	
150	10.3	242.3 (6.49)	242.7 (6.50)	243.0 (6.51)			

1. Outlet pressure setting was made at approximately 10% of the maximum capacity for the listed conditions.
 - Gray areas indicate maximum flow capacity.

Outlet Pressure Range, Control Spring Number and Color	Outlet Pressure Setting ¹		Inlet Pressure		2" (DN 50) Body Size		
					1.91 Inches (48.5 mm) Orifice Size		
					Droop from Setpoint		
PSIG	BAR	PSIG	BAR	10%	20%	30%	
				SCFH (Nm ³ /h)	SCFH (Nm ³ /h)	SCFH (Nm ³ /h)	
16 to 30 PSIG 1.1 to 2.1 BAR 655-771-003 Red	20	1.4	25	1.7	22.0 (0.59)	40.9 (1.10)	44.2 (1.18)
			30	2.1	28.9 (0.78)	52.0 (1.39)	54.5 (1.46)
			40	2.8	40.5 (1.08)	71.1 (1.90)	72.7 (1.95)
			60	4.1	60.4 (1.62)	104.7 (2.81)	105.7 (2.83)
			80	5.5	78.9 (2.12)	136.3 (3.65)	136.9 (3.67)
			100	6.9	96.9 (2.60)	167.0 (4.48)	167.6 (4.49)
			125	8.6	119.0 (3.19)	205.0 (5.49)	205.4 (5.50)
	30	2.07	150	10.3	141.0 (3.78)	242.7 (6.50)	243.0 (6.51)
			35	2.4	39.1 (1.05)	50.7 (1.36)	55.7 (1.49)
			40	2.8	50.1 (1.34)	62.1 (1.66)	66.0 (1.77)
			60	4.1	84.3 (2.26)	99.7 (2.67)	101.8 (2.73)
			80	5.5	113.6 (3.04)	132.8 (3.56)	134.3 (3.60)
			100	6.9	141.2 (3.78)	164.5 (4.41)	165.6 (4.44)
			125	8.6	174.8 (4.68)	203.1 (5.44)	203.9 (5.46)
26 to 40 PSIG 1.8 to 2.8 BAR 655-771-004 Blue	30	2.1	150	10.3	207.9 (5.57)	241.2 (6.46)	241.8 (6.48)
			35	2.4	25.0 (0.67)	50.7 (1.36)	55.7 (1.49)
			40	2.8	31.9 (0.86)	62.1 (1.66)	66.0 (1.77)
			60	4.1	53.4 (1.43)	99.7 (2.67)	101.8 (2.73)
			80	5.5	71.9 (1.93)	132.8 (3.56)	134.3 (3.60)
			100	6.9	89.3 (2.39)	164.5 (4.41)	165.6 (4.44)
			125	8.6	110.5 (2.96)	203.1 (5.44)	203.9 (5.46)
	40	2.8	45	3.1	38.5 (1.03)	60.5 (1.62)	67.1 (1.80)
			50	3.4	48.0 (1.29)	72.1 (1.93)	77.5 (2.08)
			60	4.1	63.9 (1.71)	92.5 (2.48)	96.4 (2.58)
			80	5.5	90.8 (2.43)	128.1 (3.43)	130.7 (3.50)
			100	6.9	115.0 (3.08)	161.0 (4.32)	162.9 (3.50)
			125	8.6	144.0 (3.86)	200.5 (5.37)	201.9 (5.41)
			150	10.3	172.1 (4.61)	239.1 (6.41)	240.2 (6.44)
36 to 50 PSIG 2.5 to 3.4 BAR 655-771-005 Green	40	2.8	150	10.3	138.5 (3.71)	239.1 (6.41)	240.2 (6.44)
			55	3.8	44.2 (1.18)	70.3 (1.88)	78.6 (2.11)
			60	4.1	53.9 (1.44)	82.1 (2.20)	89.0 (2.38)
			80	5.5	84.8 (2.27)	121.7 (3.26)	125.9 (3.37)
			100	6.9	110.9 (2.97)	156.4 (4.19)	159.4 (4.27)
			125	8.6	140.9 (3.78)	197.1 (5.28)	199.3 (5.34)
			150	10.3	169.7 (4.55)	236.5 (6.34)	238.2 (6.38)
	50	3.4	55	3.8	44.2 (1.18)	70.3 (1.88)	78.6 (2.11)
			60	4.1	53.9 (1.44)	82.1 (2.20)	89.0 (2.38)
			80	5.5	84.8 (2.27)	121.7 (3.26)	125.9 (3.37)
			100	6.9	110.9 (2.97)	156.4 (4.19)	159.4 (4.27)
			125	8.6	140.9 (3.78)	197.1 (5.28)	199.3 (5.34)
			150	10.3	169.7 (4.55)	236.5 (6.34)	238.2 (6.38)
			150	10.3	142.6 (3.82)	236.5 (6.34)	238.2 (6.38)
45 to 60 PSIG 3.1 to 4.1 BAR 655-771-006 White	50	3.4	65	4.5	50.0 (1.34)	80.1 (2.15)	90.1 (2.42)
			70	4.8	59.9 (1.60)	92.0 (2.47)	100.5 (2.69)
			80	5.5	77.0 (2.06)	113.2 (3.03)	119.8 (3.21)
			100	6.9	105.8 (2.84)	150.5 (4.03)	155.0 (4.15)
			125	8.6	137.5 (3.68)	192.9 (5.17)	196.2 (5.26)
			150	10.3	167.4 (4.49)	233.2 (6.25)	235.8 (6.32)
			150	10.3	142.6 (3.82)	236.5 (6.34)	238.2 (6.38)
	60	4.1	65	4.5	50.0 (1.34)	80.1 (2.15)	90.1 (2.42)
			70	4.8	59.9 (1.60)	92.0 (2.47)	100.5 (2.69)
			80	5.5	77.0 (2.06)	113.2 (3.03)	119.8 (3.21)
			100	6.9	105.8 (2.84)	150.5 (4.03)	155.0 (4.15)
			125	8.6	137.5 (3.68)	192.9 (5.17)	196.2 (5.26)
			150	10.3	167.4 (4.49)	233.2 (6.25)	235.8 (6.32)
			150	10.3	142.6 (3.82)	236.5 (6.34)	238.2 (6.38)

1. Outlet pressure setting was made at approximately 10% of the maximum capacity for the listed conditions.
 - Gray areas indicate maximum flow capacity.

P133 Parts List

Item	Description	Qty.	Part Number
1	Iron - 2" NPT	1	664-363-000
	Steel - 2" NPT		664-361-000
	Iron - 2" 125# FF Flanged		664-370-000
	Steel - 2" 150# RF Flanged		664-373-000
2	Orifice - Aluminum	1	688-054-001
3	Belleville Washer	1	662-235-000
4	O-ring - Nitrile	1	649-317-000
	O-ring - Fluorocarbon		649-317-001
5	Cage - Aluminum	1	704-007-000
6	Cage Roll Pins	3	635-072-000
7	Stem Bearing	1	602-126-000
8	L & H Diaphragm Casing - Aluminu	1	629-230-000
	K Diaphragm Casing - Steel		629-256-000
9	L & H Bonnet - Aluminum	1	604-230-000
	K Bonnet - Iron		604-564-000
L & H Vent Assembly Parts			
10	Flapper Stem - L & H Only	1	661-008-000
11	Lower Flapper - L & H Only	1	661-009-000
12	Upper Flapper - L & H Only	1	661-010-000
13	Seat Ring - L & H Only	1	650-136-000
14	Self-tapping Screw - L & H Only	3	648-502-000
15	Vent Port Spring - L & H Only	2	655-697-000
16	Screen - L & H Only	1	647-018-000
17	Snap Ring - L & H Only	1	693-021-000
18	L & H Bonnet Cap	1	610-058-000
	K Bonnet Cap		610-094-000
19	L & H Bonnet Cap Gasket	1	624-068-000
	K Bonnet Cap Gasket		624-101-000
20	L Adjustment Screw	1	648-504-000
	H Adjustment Screw		648-536-000
	K Adjustment Screw		648-571-000
21	2" to 4" WC, Brown Spring	L & H	655-697-002
	3.5" to 6" WC, Pink Spring	L & H	655-730-002
	5" to 9" WC, Tan Spring	L & H	655-730-003
	6" to 14" WC, Purple Spring	L & H	655-697-011
	8.5" to 18" WC, White Spring	L & H	655-697-005
	14" to 28" WC, Green Spring	L & H	655-697-006
	.75 to 2 PSIG, Blue Spring	L & H	655-697-007
	1.5 to 6 PSIG, Orange Spring	H	655-697-008
	2 to 5 PSIG, Yellow Spring	H	655-730-000
	5 to 10 PSIG, Grey Spring	H	655-630-001
	6 to 20 PSIG, Silver Spring	K	655-771-002
	16 to 30 PSIG, Red Spring	K	655-771-003
	26 to 40 PSIG, Blue Spring	K	655-771-004
	36 to 50 PSIG, Green Spring	K	655-771-005
	45 to 60 PSIG, White Spring	K	655-771-006
2 to 5 PSIG, Yellow Spring	K	655-771-000	
4.5 to 10 PSIG, Orange Spring	K	655-771-001	
22	L & H Range Spring Seat	1	650-171-000
	K Range Spring Seat		634-224-000
23	L Upper Diaphragm Plate - Low Pressure	1	638-071-000
	H Upper Diaphragm Plate - High Pressure		638-070-000
	K Upper Diaphragm Plate - High Pressure		638-086-000
24	L & H Nitrile Upper Diaphragm	1	618-094-000
	L & H Fluorocarbon Upper Diaphragm		618-094-001
	K Nitrile Upper Diaphragm		600-517-000
	K Fluorocarbon Upper Diaphragm		600-517-001
25	L & H Diaphragm Sealing Plate	2	638-072-000
	K Diaphragm Sealing Plate		638-087-000

Item	Description	Qty.	Part Number
26	Sealing Washer - Nitrile	2	662-231-000
	Sealing Washer - Fluorocarbon		662-231-001
27	L & H Stem - 416L Stainless Steel	1	689-007-000
	K Stem - 416L Stainless Steel		689-007-001
28	O-ring - Nitrile	2	649-000-197
	O-ring - Fluorocarbon		649-000-342
29	L & H Upper Stem Hex Nut	1	634-196-000
	K Upper Stem Hex Nut		634-146-002
30	Lower Diaphragm Plate	1	638-069-000
31	Nitrile Lower Diaphragm	1	600-511-000
	Fluorocarbon Lower Diaphragm		600-511-001
32	Washer	2	662-232-000
33	Stem Guide Bushing	1	608-082-000
34	Stem Sleeve	1	653-056-000
35	Stem E-ring	1	693-025-000
36	Roll Pin	1	635-071-000
37	Valve Disk Assembly - Nitrile	1	822-039-000
	Valve Disk Assembly - Fluorocarbon		822-039-001
38	Registration Disk	1	619-064-000
39	Washer	1	662-233-000
40	Lower Stem Hex Nut	1	634-000-031
41	Body O-ring - Nitrile	1	649-000-257
	Body O-ring - Fluorocarbon		649-318-000
42	Body/Lower Casing Studs (not shown)	4	657-016-000
43	Body/Lower Casing Lock Nut (not shown)	4	634-184-000
44	L & H Lower Casing/Bonnet Screw	12	648-506-000
	K Lower Casing/Upper Casing Screw		648-467-007
45	L & H Lower Casing/Bonnet Nut	12	634-174-000
	K Lower Casing/Upper Casing Nut		634-151-000
47	Set Screw (not shown)	2	648-534-000
48	L - Thrust Washer - High Pressure only	1	662-234-001
	H Thrust Washer - High Pressure only		662-234-000
	K Thrust Washer - High Pressure only		662-234-002
49	25% Capacity Restrictor	1	612-009-000
	40% Capacity Restrictor		612-010-000
	60% Capacity Restrictor		612-011-000
50	Restrictor Collar Set Screw	1	648-535-000
51	Upper Spring Seat - Brass	1	626-119-000
52	Vent Pipe Nipple	1	633-025-000
53	Bonnet Vent Assembly	1	836-011-000
54	Lower Casing Vent	1	622-057-000
55	Upper Diaphragm Case	1	629-255-000
56	Casing Adaptor	1	673-027-000
57	Casing Adaptor O-ring - Nitrile	1	649-309-010
	Casing Adaptor O-ring - Fluorocarbon		649-304-002
58	Lower Casing Screw	4	648-000-034
59	Diaphragm Lock Washer	1	662-000-018
60	K Roller Bearing	1	602-134-000
61	L & H Roller Washer	1	662-234-007
	K Roller Washer		662-242-000
62	Mounting Bracket Gasket	2	624-102-000
63	Adjustment Screw Jam Nut	1	634-181-000
64	Bonnet/Bracket Screws	6	648-463-002
65	Bracket/Casing Screws	6	648-463-011
66	Diaphragm Washer O-ring - Nitrile	1	649-000-150
	Diaphragm Washer O-ring - Fluorocarbon		649-000-338
67	Mounting Bracket	1	607-311-000

P133 Parts Draw-

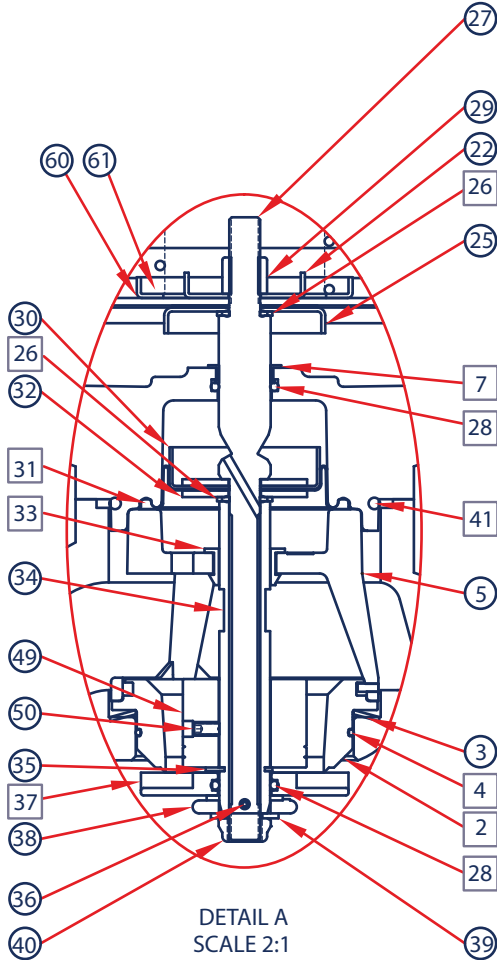

Parts included in P133 Repair Kit, 971-P13-3XX

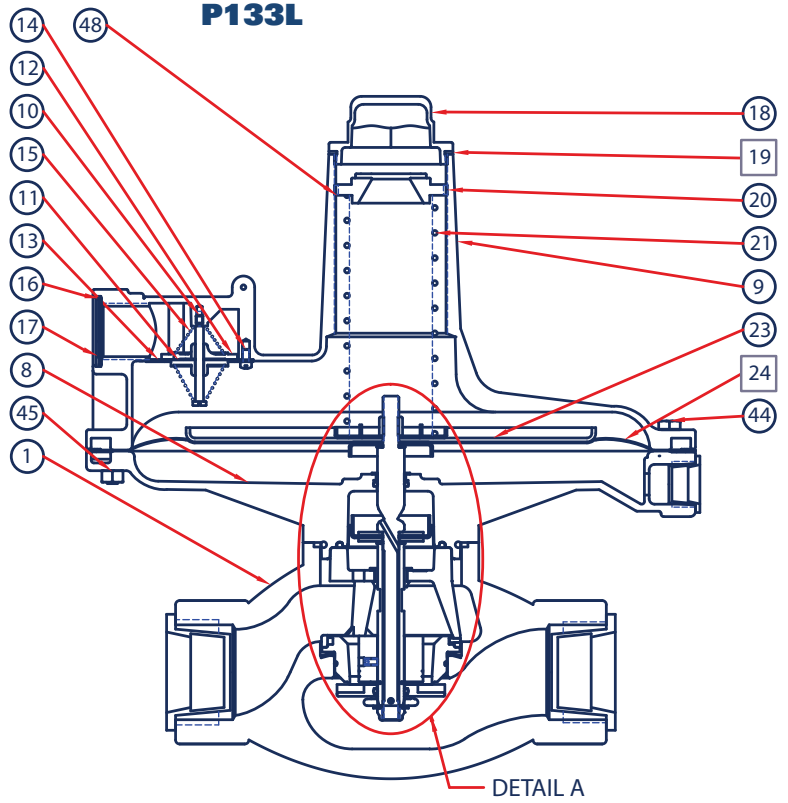

Parts included in P133 Repair Kit, 971-P13-3XX

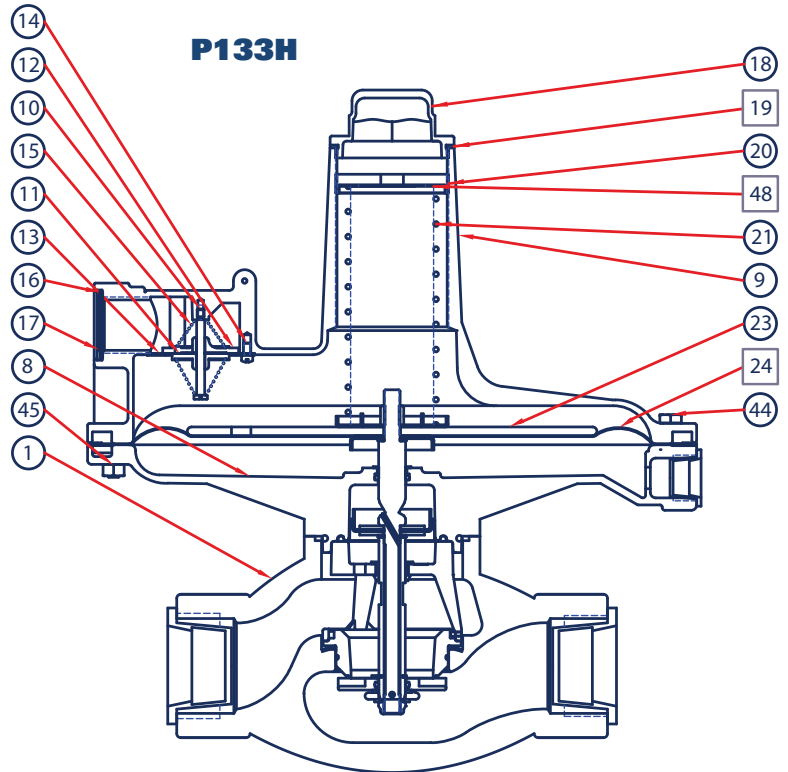

Parts included in P133 Repair Kit, 971-P13-3XX

P133 Parts Drawing

P133K

